



BINIC ABRASIVE CO.,LTD
SHANGHAI BINIC INDUSTRIAL CO.,LTD
Sales Office: #506, Yuanzhong Building, No.,1905
Hongmei Road
Shanghai, P.R.China 200233
Tel.: 0086 21 6440 1165
Fax.:0086 21 6485 0944
Email: sales@binic-china.com
Website: www.binictools.com

BINIC ABRASIVE

Company Introduction

BINIC Abrasive CO.,LTD is founded in 2005. We are the professional producer for abrasive products, which covering abrasive wheels, flap disc, wire brush, fibre disc, etc.

We provide High Quality Products and Service to user, let the customer's work be safer, highly effective and protecting the environment. Carries out the ISO 9001 quality control system comprehensively, using international advanced automation production equipment and the well appointed development laboratory to ensure the best quality control and quality assurance together with optimized production pattern.

We produced our products based on EN12413 standard and we have obtained ISO 9001:2000 certificate since 2002 and MPA certificate since 2005. Our products are well appreciated by our several satisfied and loyal customers and be well received in the market.

BSP is a brand name of BINIC Abrasive CO.,LTD, The BSP range of cutting off and grinding discs for portable and fixed machines provide superior performance in the most stringent working environment. The product range includes state-of-art solutions for cutting-off, grinding, and surface finishing operations on any materials relates to industrial fabrication markets and DIY market.



With this catalogue, BSP makes it quick and easy to select the products you need from our huge range of topquality abrasives. The clear and logical layout in ten productgroups makes it easy for you to find what you are looking for. State-of-the-art manufacturing techniques ensure that our coated abrasives fulfill the most demanding standards of surface finish, long life and stock removal.



CUTTING OFF DISC & GRINDING DISC



FLAP DISC



WIRE BRUSH



FIBRE DISC



Hand sanding

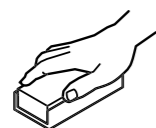

Hand block

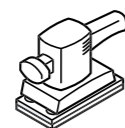

Orbital sander



Random orbital sander



Delta sander



Portable belt sander

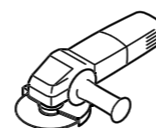

Angle grinder

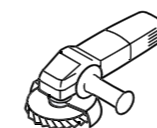

Angle grinder with abrasive mop disc

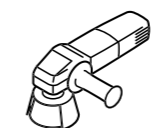

Angle grinder with cup grinding wheel

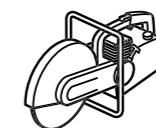

Petrol powered cutter

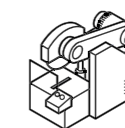

Stationary cutting machine

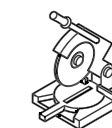

Chop saw

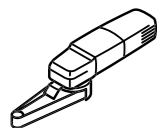

Hand tool belt grinder

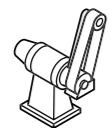

Back stand grinding machine

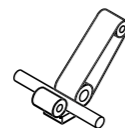

Centreless finishing machine

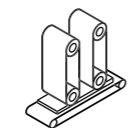

Through-feed grinding machine

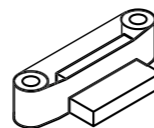

Edge sanding machine

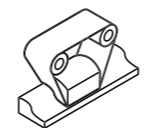

Contour finishing machine

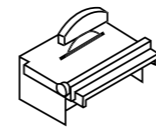

Wall chaser

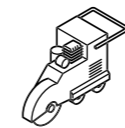

Joint cutter

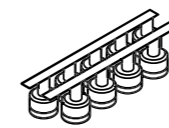

Lifting beam with mottling points

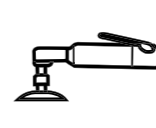

Right angle die grinder



Flexible shaft grinder

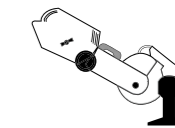

Petrol powered cutter with clamping device

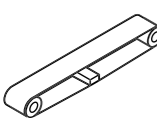

Pad / stroke sanding machine

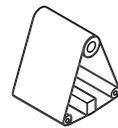

Wide belt finishing machine

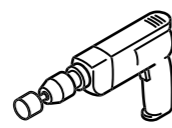

Drilling machine

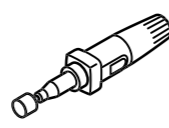

Die grinder

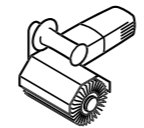

Satin finishing machine

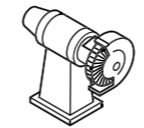

Floor-standing grinder

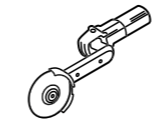

Concave fillet weld grinder

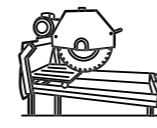
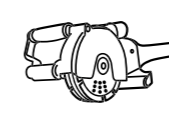

Table saw



Joint router



Stationary cutting machine



Parquet grinders

INDEX

CUTTING OFF DISC & GRINDING WHEEL

- 10 Cutting off disc
- 25 Mini Cutting Off Disc
- 26 Cutting & Grinding Disc
- 27 Grinding Wheel
- 31 Large Cut Off Wheel
- 34 Tin Box Set

FLAP DISC

- 40 Aluminium Oxide flap disc
- 42 Zirconia Aluminium flap disc
- 45 Silicon Carbide flap disc
- 47 Ceramic Aluminium Oxide flap disc
- 48 2 in 1-Calcined Alumina flap disc
- 49 Plastic Backing Flap Disc flap disc

WIRE BRUSH

- 54 Crimped Wire Cup Brush
- 55 Twisted Knot Bowl Cup Brush
- 57 Twisted Knot Cup Brush
- 58 Crimped Wire Bevel Brush
- 58 Twisted Knot Bevel Brush
- 59 Twisted Knot Wheel Brush
- 64 Circular brushes for bench wheel
- 65 Circular Brush
- 66 Shaft Mounted Cup Brush
- 71 Accessories

FIBRE DISC

- 74 Aluminium Oxide fibre disc
- 75 Zirconia Alumina fibre disc
- 75 Ceramic Aluminium Oxide fibre disc
- 76 Backing Pad

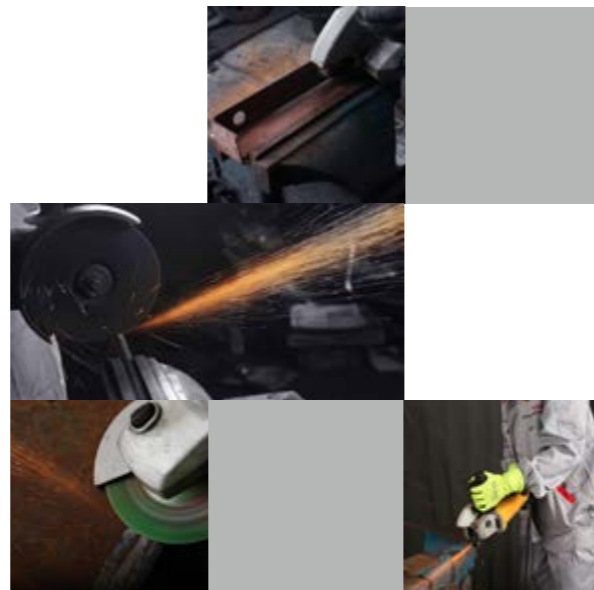

**CUTTING OFF DISC
&
GRINDING WHEEL**

Product Group

BSP label all cutting off disc and grinding wheel for different application with different colors as follows:

Application	BSP LABEL
G	
Stainless steel Steel	
Stainless Steel (INOX)	
ALU	
CAST IRON	
Stone	

BSP label



Types of resin-bonded grinding wheels

Type	Diagram	Dimensions	Description
T 41		Cutting discs b = (0,8 mm - 4,5 mm) (USA: Type 1)	Straight cutting discs. • Available in diameters from 50 (2 ") to 230 mm (9 ") for freehand applications, • from 300 mm (12 ") to 500 mm (20 ") for use in stationary machines
T 42		Cutting discs b = (0,8 mm - 4,5 mm) (USA: Type 27)	Depressed centre cutting discs. • Available in diameters from 50 (2 ") to 230 mm (9 "), allowed for freehand use.
T 27		Grinding wheels b = (4 mm - 10 mm) (USA: Type 27)	Depressed centre grinding wheels. • Available in diameters from 76 (3 ") to 230 mm (9 "), allowed for freehand use.
T 28		Grinding wheels b = (6 mm - 8 mm) (USA: Type 28)	Depressed centre grinding wheels. • Available in diameters from 76 (3 ") to 230 mm (9 "), allowed for freehand use.

CUTTING OFF DISC & GRINDING WHEEL

Construction and components of resin bonded abrasives discs



0.8mm Cutting Off Disc



Stainless Steel (INOX) / Steel Cutting T41

Features:

- The extra fine cutting disc evolution AS60 V with a thickness of 0.8mm is the right choice for cutting thin-walled profiles and pipes, thin sheet and ropes.
- The extra smooth cutting disc is characterized by its fast and smooth cutting with low contact pressure.
- For thin sheets, steel ropes, thin-walled profiles and pipes made of stainless steel and non-ferrous metals, as well as composite materials.
- Used on angle grinder, diameter of 115 mm and 125mm cutting wheels are more durable for customers.

Product advantages:

- Super-long durability
- High-speed cutting
- No need to change the wheels even for different material's cutting
- Comfortable cutting experience
- Economic



BINIC Article Nr.	Size(mm)	Shape	Specification	Application	Speed	R.P.M.
BE1001	115x0.8x22.23	T41	AS60 V-BF	SS/S	80m/s	13300
BE1002	125x0.8x22.23	T41	AS60 V-BF	SS/S	80m/s	12200



Stainless Steel (INOX) Cutting T41

Features:

- The extra fine cutting disc evolution AS60 V with a thickness of 0.8mm is the right choice for cutting thin-walled profiles and pipes, thin sheet and ropes.
- The extra smooth cutting disc is characterized by its fast and smooth cutting with low contact pressure.
- For thin sheets, steel ropes, thin-walled profiles and pipes made of stainless steel and non-ferrous metals, as well as composite materials.
- Used on angle grinder, diameter of 115 mm and 125mm cutting wheels are more durable for customers.

Product advantages:

- Super-long durability
- High-speed cutting
- No need to change the wheels even for different material's cutting
- Comfortable cutting experience
- Economic



BINIC Article Nr.	Size(mm)	Shape	Specification	Application	Speed	R.P.M.
BE1003	115x0.8x22.23	T41	WA60 V-BF	Stainless Steel (INOX)	80m/s	13300
BE1004	125x0.8x22.23	T41	WA60 V-BF	Stainless Steel (INOX)	80m/s	12200

1.0mm Cutting Off Disc

Metal Cutting T41

Features:

- Used on angle grinder, diameter of 115mm and 125mm cutting wheels are more durable for customers.
- Fast cutting for various materials with Minimum friction and low-calorie output, to reduce the pollution of the material.
- With excellent cutting performance and super-long service life for the application.

Product advantages:

- Super-long durability
- High-speed cutting
- No need to change the wheels even for different material's cutting
- Comfortable cutting experience
- Economic



BINIC Article Nr.	Size(mm)	Shape	Specification	Application	Speed	R.P.M.
BE1005	115x1.0x22.23	T41	A60 T-BF	G	80m/s	13300
BE1006	125x1.0x22.23	T41	A60 T-BF	G	80m/s	12200

1.0mm Cutting Off Disc

Stainless Steel (INOX) Cutting T41

Features:

- Used for angle grinder.
- 1.0mm thickness cutting disc can satisfy fast cutting with little burr and offer durability.
- Inox special can fastly cutting different material, minimize friction, increase sharpness, and prevent stainless steel hot corrosion.
- Have the excellent abrasive performance and extra working life in application of stainless steel, obvious advantage among the competition of various brands.
- Have the function of fastly cutting ordinary metal.

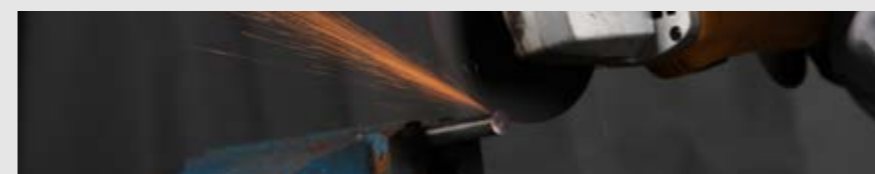

BINIC Article Nr.	Size(mm)	Shape	Specification	Application	Speed	R.P.M.
BE1009	115x1.0x22.23	T41	WA60 T-BF	Stainless Steel (INOX)	80m/s	13300
BE1010	125x1.0x22.23	T41	WA60 T-BF	Stainless Steel (INOX)	80m/s	12200



Stainless Steel (INOX) / Steel Cutting T41

Features:

- Used for angle grinder.
- 1.0mm thickness cutting disc can satisfy fast cutting with little burr and offer durability
- Inox special can fastly cutting different material, minimize friction, increase sharpness, and prevent stainless steel hot corrosion.
- Have the excellent abrasive performance and extra working life in application of stainless steel, obvious advantage among the competition of various brands.
- Have the function of fastly cutting ordinary metal.



BINIC Article Nr.	Size(mm)	Shape	Specification	Application	Speed	R.P.M.
BE1007	115x1.0x22.23	T41	AS60 T-BF	SS/S	80m/s	13300
BE1008	125x1.0x22.23	T41	AS60 T-BF	SS/S	80m/s	12200

Aluminium Cutting T41

Features:

- Aluminium is used for cutting various profiles, make no pollution and surface damage.
- Increasing feed pressure avoids the safety hazard made by fracture when cutting
- Prevent slow cutting or unable cutting made by air hole blocking when cutting.
- Maximize the friction and sharpness, cost less than diamond blade.
- 1.0mm thickness widely used for various cutting, less dust when cutting.



BINIC Article Nr.	Size(mm)	Shape	Specification	Application	Speed	R.P.M.
BE1011	115x1.0x22.23	T41	CA 60 ALU	Alu	80m/s	13300
BE1012	125x1.0x22.23	T41	CA 60 ALU	Alu	80m/s	12200



1.6-2.0mm Cutting Off Disc - Fe/S/Cl ≤ 0,1%

Stainless Steel (INOX) / Steel Cutting T41 / T42

Features:

- Free from iron, sulphur and chlorine. Special disc for cutting stainless steel. For food industrial.
- Used for 4" 4 1/2" 5" 6" 7" 9" grinder, 4" 4 1/2" 5" 6" 7" 9" diameter products are suit to America market.
- .045" thickness can fastly cut different material, minimize the friction and increase side sharpness.
- .062" thickness widely used for various cutting application. Increase side strength to ensure safer application.
- Has perfect abrasive performance and extra durability on application of steel, obvious advantage among the competition of various brands.



BINIC Article Nr.	Size	Shape	Specification	Application	Speed	R.P.M.
BE1127	100x1.6x16	T41	AS60 T-BF	SS/S	80m/s	15300
BE1128	115x1.6x22.23	T41	AS60 T-BF	SS/S	80m/s	13300
BE1129	125x1.6x22.23	T41	AS60 T-BF	SS/S	80m/s	12200
BE1130	150x1.6x22.23	T41	AS60 T-BF	SS/S	80m/s	10200
BE1131	180x1.6x22.23	T41	AS60 T-BF	SS/S	80m/s	8600
BE1132	230x1.9x22.23	T41	AS60 T-BF	SS/S	80m/s	6600

BINIC Article Nr.	Size	Shape	Specification	Application	Speed	R.P.M.
BE1133	100x1.6x16	T42	AS60 T-BF	SS/S	80m/s	15300
BE1134	115x1.6x22.23	T42	AS60 T-BF	SS/S	80m/s	13300
BE1135	125x1.6x22.23	T42	AS60 T-BF	SS/S	80m/s	12200
BE1136	150x1.6x22.23	T42	AS60 T-BF	SS/S	80m/s	10200
BE1137	180x1.6x22.23	T42	AS60 T-BF	SS/S	80m/s	8600
BE1139	230x1.9x22.23	T42	AS60 T-BF	SS/S	80m/s	6600

1.6-2.0mm Cutting Off Disc

Stainless Steel (INOX) / Steel Cutting T41

Features:

- Used for angle grinder.
- 1.6mm thickness can fastly cut different material, minimize the friction and increase side sharpness.
- Has perfect abrasive performance and extra durability on application of steel, obvious advantage among the competition of various brands.



BINIC Article Nr.	Size(mm)	Shape	Specification	Application	Speed	R.P.M.
BE1019	100x1.6x16	T41	AS46 T-BF	SS/S	80m/s	15300
BE1020	115x1.6x22.23	T41	AS46 T-BF	SS/S	80m/s	13300
BE1021	125x1.6x22.23	T41	AS46 T-BF	SS/S	80m/s	12200
BE1022	150x1.6x22.23	T41	AS46 T-BF	SS/S	80m/s	10200
BE1023	180x1.6x22.23	T41	AS46 T-BF	SS/S	80m/s	8600
BE1024	230x1.9x22.23	T41	AS46 T-BF	SS/S	80m/s	6600

Stainless Steel (INOX) / Steel Cutting T42

Features:

- Used for angle grinder.
- 1.6mm thickness can fastly cut different material, minimize the friction and increase side sharpness.
- Has perfect abrasive performance and extra durability on application of steel, obvious advantage among the competition of various brands.



BINIC Article Nr.	Size(mm)	Shape	Specification	Application	Speed	R.P.M.
BE1025	100x1.6x16	T42	AS46 T-BF	SS/S	80m/s	15300
BE1026	115x1.6x22.23	T42	AS46 T-BF	SS/S	80m/s	13300
BE1027	125x1.6x22.23	T42	AS46 T-BF	SS/S	80m/s	12200
BE1028	150x1.6x22.23	T42	AS46 T-BF	SS/S	80m/s	10200
BE1029	180x1.6x22.23	T42	AS46 T-BF	SS/S	80m/s	8600
BE1030	230x1.9x22.23	T42	AS46 T-BF	SS/S	80m/s	6600

1.6-2.0mm Cutting Off Disc

Stainless Steel (INOX) Cutting T41

Features:

- Used for angle grinder.
- 1.6mm thickness cutting disc can satisfy fast cutting with little burr and offer durability.
- Inox special can fastly cutting different material, minimize friction, increase sharpness, and prevent stainless steel hot corrosion.
- Have the excellent abrasive performance and extra working life in application of stainless steel, obvious advantage among the competition of various brands.
- Have the function of stainless steel ordinary metal.



BINIC Article Nr.	Size(mm)	Shape	Specification	Application	Speed	R.P.M.
BE1031	100x1.6x16	T41	WA46 T-BF	Stainless Steel (INOX)	80m/s	15300
BE1032	115x1.6x22.23	T41	WA46 T-BF	Stainless Steel (INOX)	80m/s	13300
BE1033	125x1.6x22.23	T41	WA46 T-BF	Stainless Steel (INOX)	80m/s	12200
BE1034	150x1.6x22.23	T41	WA46 T-BF	Stainless Steel (INOX)	80m/s	10200
BE1035	180x1.6x22.23	T41	WA46 T-BF	Stainless Steel (INOX)	80m/s	8600
BE1036	230x1.9x22.23	T41	WA46 T-BF	Stainless Steel (INOX)	80m/s	6600
BE1037	100x1.6x16	T42	WA46 T-BF	Stainless Steel (INOX)	80m/s	15300
BE1038	115x1.6x22.23	T42	WA46 T-BF	Stainless Steel (INOX)	80m/s	13300
BE1039	125x1.6x22.23	T42	WA46 T-BF	Stainless Steel (INOX)	80m/s	12200
BE1040	150x1.6x22.23	T42	WA46 T-BF	Stainless Steel (INOX)	80m/s	10200
BE1041	180x1.6x22.23	T42	WA46 T-BF	Stainless Steel (INOX)	80m/s	8600
BE1042	230x1.9x22.23	T42	WA46 T-BF	Stainless Steel (INOX)	80m/s	6600

1.6-2.0mm Cutting Off Disc

Aluminium Cutting T41

Features:

- Aluminium is used for cutting various profiles, make no pollution and surface damage.
- Increasing feed pressure avoids the safety hazard made by fracture when cutting.
- Prevent slow cutting or unable cutting made by air hole blocking when cutting.
- Maximize the friction and sharpness, cost less than diamond blade.
- 1.6mm thickness widely used for various cutting, less dust when cutting.



BINIC Article Nr.	Size(mm)	Shape	Specification	Application	Speed	R.P.M.
BE1043	100x1.6x16	T41	CA46 ALU	Alu	80m/s	15300
BE1044	115x1.6x22.23	T41	CA46 ALU	Alu	80m/s	13300
BE1045	125x1.6x22.23	T41	CA46 ALU	Alu	80m/s	12200
BE1046	150x1.6x22.23	T41	CA46 ALU	Alu	80m/s	10200
BE1047	180x1.6x22.23	T41	CA46 ALU	Alu	80m/s	8600
BE1047	230x1.9x22.23	T41	CA46 ALU	Alu	80m/s	6600

1.6-2.0mm Cutting Off Disc



Stainless Steel (INOX) / Steel Cutting T41

Features:

- Used angle forgrinde.
- 2.0mmthickness can fastly cut different material, minimize the friction and increase sharpness.
- Has perfect abrasive performance and extra durability on application of steel, obvious advantage among the competition of various brands.



BINIC Article Nr.	Size(mm)	Shape	Specification	Application	Speed	R.P.M.
BE1049	115x2.0x22.23	T41	AS46 T-BF	SS/S	80m/s	13300
BE1050	125x2.0x22.23	T41	AS46 T-BF	SS/S	80m/s	12200
BE1051	180x2.0x22.23	T41	AS46 T-BF	SS/S	80m/s	8600
BE1055	115x2.0x22.23	T42	AS46 T-BF	SS/S	80m/s	13300
BE1056	125x2.0x22.23	T42	AS46 T-BF	SS/S	80m/s	12200
BE1057	180x2.0x22.23	T42	AS46 T-BF	SS/S	80m/s	8600

2.5-3.0mm Series



Stainless Steel (INOX) / Steel Cutting T41

Features:

- Used for angle grinder.
- Can fastly cutting different material, minimize friction, increase sharpness, and prevent stainless steel hot corrosion.
- 2.5mm&3.0mm thickness widely used for various cutting application. Increase side strength to ensure safer application. Improve the side stability and guarantee guide precision of cutting disc.
- Have the excellent abrasive performance and extra working life in application of stainless steel, obvious advantage among the competitive of various brands.



BINIC Article Nr.	Size(mm)	Shape	Specification	Application	Speed	R.P.M.
BE1064	100x2.5x16	T41	AS30 S-BF	SS/S	80m/s	15300
BE1065	115x2.5x22.23	T41	AS30 S-BF	SS/S	80m/s	13300
BE1066	115x3.0x22.23	T41	AS30 S-BF	SS/S	80m/s	13300
BE1067	125x2.5x22.23	T41	AS30 S-BF	SS/S	80m/s	12200
BE1068	125x3.0x22.23	T41	AS30 S-BF	SS/S	80m/s	12200
BE1069	150x2.5x22.23	T41	AS30 S-BF	SS/S	80m/s	10200
BE1070	150x3.0x22.23	T41	AS30 S-BF	SS/S	80m/s	10200
BE1071	180x3.0x22.23	T41	AS30 S-BF	SS/S	80m/s	8600
BE1072	230x3.0x22.23	T41	AS30 S-BF	SS/S	80m/s	6600

Stainless Steel (INOX) Cutting T41

Features:

- Used for angle grinder.
- 2.0mm thickness cutting disc can satisfy fast cutting with little burr and offer durability.
- Inox special can fastly cutting different material, minimize friction, increase sharpness, and prevent stainless steel hot corrosion.
- Have the excellent abrasive performance and extra working life in application of stainless steel, obvious advantage among the competition of various brands.
- Have the function of fastly cutting ordinary metal.



BINIC Article Nr.	Size(mm)	Shape	Specification	Application	Speed	R.P.M.
BE1052	115x2.0x22.23	T41	WA46 T-BF	Stainless Steel (INOX)	80m/s	13300
BE1053	125x2.0x22.23	T41	WA46 T-BF	Stainless Steel (INOX)	80m/s	12200
BE1054	180x2.0x22.23	T41	WA46 T-BF	Stainless Steel (INOX)	80m/s	8600
BE1058	115x2.0x22.23	T42	WA46 T-BF	Stainless Steel (INOX)	80m/s	13300
BE1059	125x2.0x22.23	T42	WA46 T-BF	Stainless Steel (INOX)	80m/s	12200
BE1060	180x2.0x22.23	T42	WA46 T-BF	Stainless Steel (INOX)	80m/s	8600

2.5-3.0mm Series

Stainless Steel (INOX) / Steel Cutting

T42

Features:

- Used for angle grinder.
- Can fastly cutting different material, minimize friction, increase sharpness, and prevent stainless steel hot corrosion.
- 2.5mm&3.0mm thickness widely used for various cutting application. Increase side strength to ensure safer application. Improve the side stability and guarantee guide precision of cutting disc.
- Have the excellent abrasive performance and extra working life in application of stainless steel, obvious advantage among the competitive of various brands.



BINIC Article Nr.	Size(mm)	Shape	Specification	Application	Speed	R.P.M.
BE1073	100x2.5x16	T42	AS30 S-BF	SS/S	80m/s	15300
BE1074	115x2.5x22.23	T42	AS30 S-BF	SS/S	80m/s	13300
BE1075	115x3.0x22.23	T42	AS30 S-BF	SS/S	80m/s	13300
BE1076	125x2.5x22.23	T42	AS30 S-BF	SS/S	80m/s	12200
BE1077	125x3.0x22.23	T42	AS30 S-BF	SS/S	80m/s	12200
BE1078	150x2.5x22.23	T42	AS30 S-BF	SS/S	80m/s	10200
BE1079	150x3.0x22.23	T42	AS30 S-BF	SS/S	80m/s	10200
BE1080	180x3.0x22.23	T42	AS30 S-BF	SS/S	80m/s	8600
BE1081	230x3.0x22.23	T42	AS30 S-BF	SS/S	80m/s	6600

2.5-3.0mm Series

Metal Cutting

T41

Features:

- Used on angle grinder.
- Fast cutting for various materials with Minimum friction and low-calorie output, to reduce the pollution of the material.
- With excellent cutting performance and super-long service life for the application.

Product advantages:

- Super-long durability.
- High-speed cutting.
- No need to change the wheels even for different material's cutting.
- Comfortable cutting experience.



BINIC Article Nr.	Size(mm)	Shape	Specification	Application	Speed	R.P.M.
BE1082	100x2.5x16	T41	A30 S-BF	G	80m/s	15300
BE1083	115x2.5x22.23	T41	A30 S-BF	G	80m/s	13300
BE1084	115x3.0x22.23	T41	A30 S-BF	G	80m/s	13300
BE1085	125x2.5x22.23	T41	A30 S-BF	G	80m/s	12200
BE1086	125x3.0x22.23	T41	A30 S-BF	G	80m/s	12200
BE1087	150x2.5x22.23	T41	A30 S-BF	G	80m/s	10200
BE1088	150x3.0x22.23	T41	A30 S-BF	G	80m/s	10200
BE1089	180x3.0x22.23	T41	A30 S-BF	G	80m/s	8600
BE1090	230x3.0x22.23	T41	A30 S-BF	G	80m/s	6600

2.5-3.0mm Series

Metal Cutting T42

Features:

- Used on angle grinder.
- Fast cutting for various materials with Minimum friction and low-calorie output, to reduce the pollution of the material.
- With excellent cutting performance and super-long service life for the application.

Product advantages:

- Super-long durability
- High-speed cutting
- No need to change the wheels even for different material's cutting
- Comfortable cutting experience



BINIC Article Nr.	Size(mm)	Shape	Specification	Application	Speed	R.P.M.
BE1091	100x2.5x16	T42	A30 S-BF	G	80m/s	15300
BE1092	115x2.5x22.23	T42	A30 S-BF	G	80m/s	13300
BE1093	115x3.0x22.23	T42	A30 S-BF	G	80m/s	13300
BE1094	125x2.5x22.23	T42	A30 S-BF	G	80m/s	12200
BE1094	125x3.0x22.23	T42	A30 S-BF	G	80m/s	12200
BE1096	150x2.5x22.23	T42	A30 S-BF	G	80m/s	10200
BE1097	150x3.0x22.23	T42	A30 S-BF	G	80m/s	10200
BE1098	180x3.0x22.23	T42	A30 S-BF	G	80m/s	8600
BE1099	230x3.0x22.23	T42	A30 S-BF	G	80m/s	6600

2.5-3.0mm Series

Steel Cutting T41 / T42

Features:

- Used on angle grinder.
- Fast cutting for various materials with Minimum friction and low-calorie output, to reduce the pollution of the material.
- With excellent cutting performance and super-long service life for the application.

Product advantages:

- Super-long durability
- High-speed cutting
- No need to change the wheels even for different material's cutting
- Comfortable cutting experience



BINIC Article Nr.	Size(mm)	Shape	Specification	Application	Speed	R.P.M.
BE1110	100x2.5x16	T41	A30 S-BF	S	80m/s	15300
BE1111	115x2.5x22.23	T41	A30 S-BF	S	80m/s	13300
BE1112	115x3.0x22.23	T41	A30 S-BF	S	80m/s	13300
BE1113	125x2.5x22.23	T41	A30 S-BF	S	80m/s	12200
BE1114	125x3.0x22.23	T41	A30 S-BF	S	80m/s	12200
BE1115	150x2.5x22.23	T41	A30 S-BF	S	80m/s	10200
BE1116	150x3.0x22.23	T41	A30 S-BF	S	80m/s	10200
BE1117	180x3.0x22.23	T41	A30 S-BF	S	80m/s	8600
BE1118	230x3.0x22.23	T41	A30 S-BF	S	80m/s	6600
BE1119	100x2.5x16	T42	A30 S-BF	S	80m/s	15300
BE1120	115x2.5x22.23	T42	A30 S-BF	S	80m/s	13300
BE1121	115x3.0x22.23	T42	A30 S-BF	S	80m/s	13300
BE1122	125x2.5x22.23	T42	A30 S-BF	S	80m/s	12200
BE1123	125x3.0x22.23	T42	A30 S-BF	S	80m/s	12200
BE1124	150x2.5x22.23	T42	A30 S-BF	S	80m/s	10200
BE1125	150x3.0x22.23	T42	A30 S-BF	S	80m/s	10200
BE1126	180x3.0x22.23	T42	A30 S-BF	S	80m/s	8600
BE1127	230x3.0x22.23	T42	A30 S-BF	S	80m/s	6600

2.5-3.0mm Series



Stone Cutting T41

Features

- Substitute products of diamond cutting wheel for concrete. Used for cutting various stone materials, No pollution and damage on work-piece surface after cutting.
- Feed pressure is increased to avoid potential safety hazard caused by fracture when cutting.
- Cutting for various section bars. No pollution and damage on work-piece surface after cutting.
- Prevent the products from clogging pores to cause slow cutting or unable to cut.
- Maximize the friction to improve sharpness, More cost saving than cutting by alloy blade.
- Smooth and flexible handle for cutting steel with various steel shapes.

Product advantages

- Fine Durability
- Tiy Dust
- Glossy cutting surface
- No Clogging
- Economic



BINIC Article Nr.	Size(mm)	Shape	Specification	Application	Speed	R.P.M.
BE1128	100x2.5x16	T41	C30 S-BF	ST	80m/s	15300
BE1129	115x2.5x22.23	T41	C30 S-BF	ST	80m/s	13300
BE1130	115x3.0x22.23	T41	C30 S-BF	ST	80m/s	13300
BE1131	125x2.5x22.23	T41	C30 S-BF	ST	80m/s	12200
BE1132	125x3.0x22.23	T41	C30 S-BF	ST	80m/s	12200
BE1133	150x2.5x22.23	T41	C30 S-BF	ST	80m/s	10200
BE1134	150x3.0x22.23	T41	C30 S-BF	ST	80m/s	10200
BE1135	180x3.0x22.23	T41	C30 S-BF	ST	80m/s	8600
BE1136	230x3.0x22.23	T41	C30 S-BF	ST	80m/s	6600

2.5-3.0mm Series



Stone Cutting T42

Features

- Substitute products of diamond cutting wheel for concrete. Used for cutting various stone materials, No pollution and damage on work-piece surface after cutting.
- Feed pressure is increased to avoid potential safety hazard caused by fracture when cutting.
- Cutting for various section bars. No pollution and damage on work-piece surface after cutting.
- Prevent the products from clogging pores to cause slow cutting or unable to cut.
- Maximize the friction to improve sharpness, More cost saving than cutting by alloy blade.
- Smooth and flexible handle for cutting steel with various steel shapes.

Product advantages

- Fine Durability
- Tiy Dust
- Glossy cutting surface
- No Clogging
- Economic

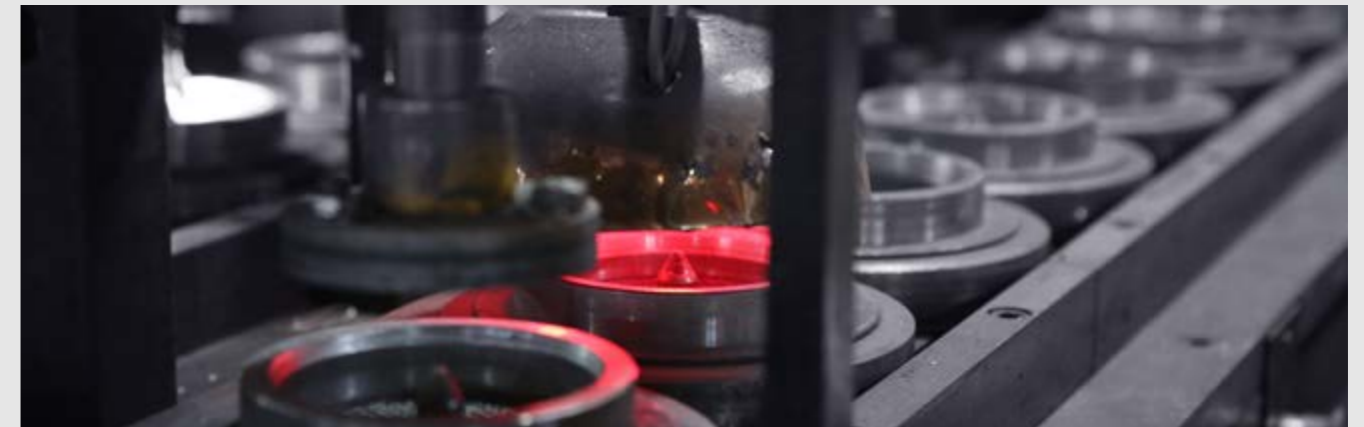

BINIC Article Nr.	Size(mm)	Shape	Specification	Application	Speed	R.P.M.
BE1137	100x2.5x16	T42	C30 S-BF	ST	80m/s	15300
BE1138	115x2.5x22.23	T42	C30 S-BF	ST	80m/s	13300
BE1139	115x3.0x22.23	T42	C30 S-BF	ST	80m/s	13300
BE1140	125x2.5x22.23	T42	C30 S-BF	ST	80m/s	12200
BE1141	125x3.0x22.23	T42	C30 S-BF	ST	80m/s	12200
BE1142	150x2.5x22.23	T42	C30 S-BF	ST	80m/s	10200
BE1143	150x3.0x22.23	T42	C30 S-BF	ST	80m/s	10200
BE1144	180x3.0x22.23	T42	C30 S-BF	ST	80m/s	8600
BE1145	230x3.0x22.23	T42	C30 S-BF	ST	80m/s	6600

Mini Cutting Off Disc



Stainless Steel (INOX) / Steel Cutting T41

Features

- Can fastly cutting different material, minimize friction, increase sharpness, and prevent Stainless steel hot corrosion.
- Application. Improve the side stability and guarantee guide precision of cutting disc.
- Have the excellent abrasive performance and extra working life in application of stainless steel, Obvious advantage among the competition of various brands.
- Have the function of fastly cutting ordinary metal.

Product advantages

- Extra durability
- High-speed cutting
- High-break-resistance
- Comfortable cutting Experience
- Economic



BINIC Article Nr.	Size(mm)	Shape	Specification	Application
BE1146	50x1.0x6	T41	AS60 T-BF	ss/s
BE1147	50x2.0x6	T41	AS60 T-BF	ss/s
BE1148	60x2.0x6	T41	AS60 T-BF	ss/s
BE1149	76x1.2x10	T41	AS60 T-BF	ss/s
BE1150	76x2.0x6	T41	AS60 T-BF	ss/s
BE1151	50x1.0x6	T41	A60 T-BF	G
BE1152	50x2.0x6	T41	A46 T-BF	G
BE1153	60x2.0x6	T41	A46 T-BF	G
BE1154	76x1.0x10	T41	A60 T-BF	G
BE1155	76x2.0x6	T41	A46 T-BF	G



Cutting & Grinding Disc



Stainless Steel (INOX) / Steel Cutting T41

Features:

- Designed and manufactured to perform both cutting and grinding.
- Very uniform, high density grain structure is extremely durable and self sharpening for long life and cooler cut.
- Available in 1.9mm, 2.5mm thickness when you need to cut, notch and grind.
- They are specially reinforced to withstand the stress in off-hand cutting applications, so whether you are cutting, grooving, notching or doing some occasional light grinding, these wheels are guaranteed to provide the longest wheel life, fastest material removal and maximum safety.
- Hold their cutting edge longer to give you a cutting life beyond compare.
- Equipped with an exclusive metal hub cladding for extra strength and control.



BINIC Article Nr.	Size(mm)	Shape	Application	Speed	R.P.M.
BE1061	115x1.9x22.23	T41	SS/S	80m/s	13300
BE1062	125x1.9x22.23	T41	SS/S	80m/s	12200
BE1063	180 x 2.5 x 22.23	T41	SS/S	80m/s	12200

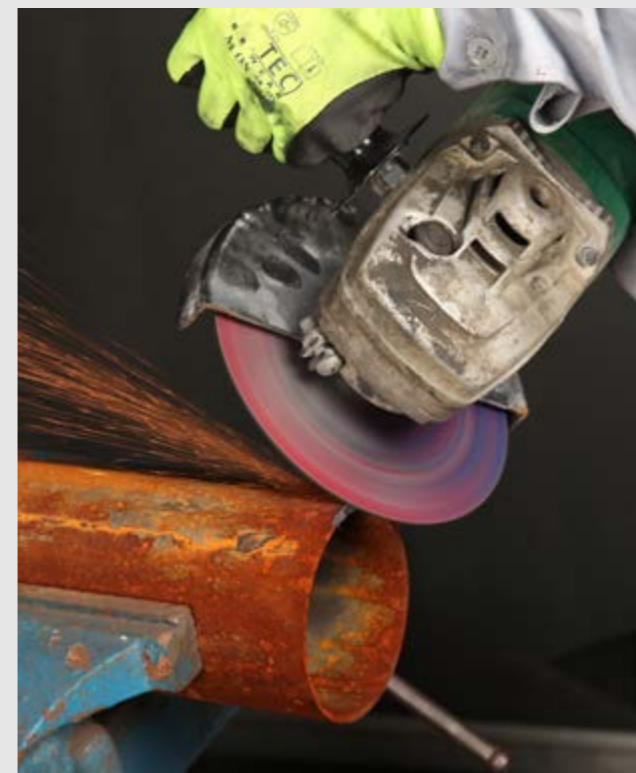

Grinding Wheel

Metal Grinding T27

Features:

- Used for medium/high power angle machines, display the best performance.
- Used for high stress working, excellent abrasive performance, high stability in grinding pipe.
- Metal grinding disc provides a high burr removal capability of the general types of iron and steel to give maximum performance and long life.
- Metal grinding especially profile plates, rebar and steel structures, such as iron and steels. It's generally used in surface grinding, rust removal, welding burrs also in processes like grinding of corners and burring after iron foundry operations.
- Perfect abrasive performance and extra durability on application of steel.



BINIC Article Nr.	Size(mm)	Shape	Specification	Application	Speed	R.P.M.
BE1156	115x4.0x22.23	T27	A30 R-BF	G	80m/s	13300
BE1157	125x4.0x22.23	T27	A30 R-BF	G	80m/s	12200
BE1158	115x6.0x22.23	T27	A24 R-BF	G	80m/s	13300
BE1159	125x6.0x22.23	T27	A24 R-BF	G	80m/s	12200
BE1160	150x6.0x22.23	T27	A24 R-BF	G	80m/s	10200
BE1161	180x4.0x22.23	T27	A30 R-BF	G	80m/s	8600
BE1162	180x6.0x22.23	T27	A24 R-BF	G	80m/s	8600
BE1163	180x7.0x22.23	T27	A24 R-BF	G	80m/s	8600
BE1164	180x8.0x22.23	T27	A24 R-BF	G	80m/s	8600
BE1165	230x6.0x22.23	T27	A24 R-BF	G	80m/s	6600
BE1166	230x7.0x22.23	T27	A24 R-BF	G	80m/s	6600
BE1167	230x8.0x22.23	T27	A24 R-BF	G	80m/s	6600

Grinding Wheel

Stainless Steel (INOX) / Steel Grinding T27

Features:

- Used for angle grinder.
- Can fastly grinding different material, minimize friction, increase sharpness, and prevent stainless steel hot corrosion.
- Have the excellent abrasive performance and extra working life in application of stainless steel, obvious advantage among the competition of various brands.

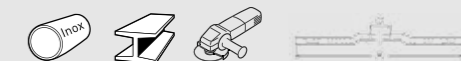

BINIC Article Nr.	Size(mm)	Shape	Specification	Application	Speed	R.P.M.
BE1168	115x4.0x22.23	T27	AS30 R-BF	SS/S	80m/s	13300
BE1169	115x4.0x22.23	T27	AS30 R-BF	SS/S	80m/s	12200
BE1170	115x6.0x22.23	T27	AS24 R-BF	SS/S	80m/s	13300
BE1171	125x6.0x22.23	T27	AS24 R-BF	SS/S	80m/s	12200
BE1172	150x6.0x22.23	T27	AS24 R-BF	SS/S	80m/s	10200
BE1173	180x4.0x22.23	T27	AS30 R-BF	SS/S	80m/s	8600
BE1174	180x6.0x22.23	T27	AS24 R-BF	SS/S	80m/s	8600
BE1175	180x7.0x22.23	T27	AS24 R-BF	SS/S	80m/s	8600
BE1176	180x8.0x22.23	T27	AS24 R-BF	SS/S	80m/s	8600
BE1177	230x6.0x22.23	T27	AS24 R-BF	SS/S	80m/s	6600
BE1178	230x7.0x22.23	T27	AS24 R-BF	SS/S	80m/s	6600
BE1179	230x8.0x22.23	T27	AS24 R-BF	SS/S	80m/s	6600

Grinding Wheel

Cast Iron Grinding T27

Features:

- Substitute products of diamond cutting wheel for cast iron. Used for cutting various stone materials, No pollution and damage on work-piece surface after cutting.
- Feed pressure is increased to avoid potential safety hazard caused by fracture when cutting.
- Cutting for various section bars. No pollution and damage on work-piece surface after cutting.
- Prevent the products from clogging pores to cause slow cutting or unable to cut.
- Maximize the friction to improve sharpness, More cost saving than cutting by alloy blade.
- Smooth and flexible handle for cutting steel with various steel shapes.

Product advantages:

- Fine Durability



BINIC Article Nr.	Size(mm)	Shape	Specification	Application	Speed	R.P.M.
BE1180	180x7.0x22.23	T27	CA24 S-BF	cast iron	80m/s	8600
BE1181	180x7.0x22.23	T27	CA24 S-BF	cast iron	80m/s	6600

Alu Grinding T27

Features:

- Aluminium is used for cutting various profiles, make no pollution and surface damage.
- Increasing feed pressure avoids the safety hazard made by fracture when cutting
- Prevent slow cutting or unable cutting made by air hole blocking when cutting.
- Maximize the friction and sharpness, cost less than diamond blade.
- 6.0mm thickness widely used for various cutting, less dust when cutting.



BINIC Article Nr.	Size(mm)	Shape	Specification	Application	Speed	R.P.M.
BE1182	115x6.0x22.23	T27	CA24 ALU	Alu	80m/s	13300
BE1183	125x6.0x22.23	T27	CA24 ALU	Alu	80m/s	12200
BE1184	150x6.0x22.23	T27	CA24 ALU	Alu	80m/s	10200
BE1185	180x6.0x22.23	T27	CA24 ALU	Alu	80m/s	8600
BE1186	230x6.0x22.23	T27	CA24 ALU	Alu	80m/s	6600

Grinding Wheel

Stone Grinding T27

Features:

- Used for low grinding working, excellent abrasive performance, high stability in grinding pipe.
- No impurity after grinding, no need further processing, can weld immediately after grinding.
- Various grinding applications, increase side strength to ensure safer application.



BINIC Article Nr.	Size(mm)	Shape	Specification	Application	Speed	R.P.M.
BE1187	115x6.0x22.23	T27	C24 R-BF	ST	80m/s	13300
BE1188	125x6.0x22.23	T27	C24 R-BF	ST	80m/s	12200
BE1189	150x6.0x22.23	T27	C24 R-BF	ST	80m/s	10200
BE1190	180x6.0x22.23	T27	C24 R-BF	ST	80m/s	8600
BE1191	230x6.0x22.23	T27	C24 R-BF	ST	80m/s	6600



Mini Grinding Wheel T27

Features:

- Used for medium/high power angle machines, display the best performance.
- Used for high stress working, excellent abrasive performance, high stability in grinding pipe.
- Metal grinding disc provides a high burr removal capability of the general types of iron and steel to give maximum performance and long life.
- Metal grinding especially profile plates, rebar and steel structures, such as iron and steels. It's generally used in surface grinding, rust removal, welding burrs also in processes like grinding of corners and burring after iron foundry operations.
- Perfect abrasive performance and extra durability on application of steel.



BINIC Article Nr.	Size(mm)	Shape	Specification	Application
BE1192	50x6.0x6	T27	A30 S-BF	G
BE1193	60x6.0x6	T27	A30 S-BF	G
BE1194	76x6.0x10	T27	A30 S-BF	G



Large Cut Off Wheel For Stationary Machine

For steel in 3-5KW 100m/s

Features:

- Used for fixed cutting machine, 3.5mm thickness, offer users more durability, suitable for most high requirement customers.
- Maximize the friction and sharpness, reduce the burrs after cutting.
- Various cutting applications, increase side strength to ensure safer application.
- Has perfect abrasive performance and extra durability on application of steel.

Product advantages:

- Superior Durability
- High break-resistance
- Economic
- Ultrahigh cutting speed
- Comfortable cutting experience
- No block



BINIC Article Nr.	Size(mm)	Specificatio	Speed
BE1195	300 x 3.5 x 22.23	A24 S-BF	100m/s
BE1196	300 x 3.5 x 25.4	A24 S-BF	100m/s
BE1197	350 x 4.0 x 25.4	A24 S-BF	100m/s
BE1198	400 x 4.5 x 25.4	A24 S-BF	100m/s

Large Cut Off Wheel For Railway

Features

- Used for cutting railway.
- Maximize the friction and sharpness.
- Various cutting applications, increase side strength to ensure safer application.
- Perfect abrasive performance and extra durability on application of steel.

Product advantages

- Superior Durability
- Ultrahigh cutting speed
- High break-resistance
- Comfortable cutting experience
- Economic
- No block



BINIC Article Nr.	Size(mm)	Specification	Speed
BE1202	300 x 3.5 x 22.23	A30 R-BF	100m/s
BE1203	300 x 3.5 x 25.4	A30 R-BF	100m/s
BE1204	350 x 4.0 x 22.23	A30 R-BF	100m/s
BE1205	350 x 4.0 x 25.4	A30 R-BF	100m/s
BE1206	400 x 4.0 x 25.4	A30 R-BF	100m/s



For steel under 3KW 80m/s

Features:

- Used for 2.5mm thickness, offer users more durability, suitable for most high requirement customers.
- Maximize the friction and sharpness, reduce the burrs after cutting.
- Various cutting applications, increase side strength to ensure safer application.
- Has perfect abrasive performance and extra durability on application of steel.

Product advantages:

- Superior Durability
- High break-resistance
- Economic
- Ultrahigh cutting speed
- Comfortable cutting experience
- No block



BINIC Article Nr.	Size(mm)	Specification	Speed
BE1199	300 x 2.5 x 25.4	A30 Q-BF	80m/s
BE1200	350 x 3.0 x 25.4	A30 Q-BF	80m/s
BE1201	400 x 3.5 x 25.4	A30 Q-BF	80m/s

Large Cutting Off Disc For Chop Saw

Features

- Used for 14" chop saw, 14" diameter, 0.12" thickness, offer users more durability, suitable for most high requirement customers.
- Maximize the friction and sharpness.
- Various cutting applications, increase side strength to ensure safer application.
- Has perfect abrasive performance and extra durability on application of steel.

Product advantages

- Superior Durability
- High break-resistance
- Economic
- Ultrahigh cutting speed
- Comfortable cutting experience
- No block



BINIC Article Nr.	Size(mm)	Specification	Speed
BE1214	300x3.5x22.23	A30 Q-BF	80m/s
BE1215	350x4.5x25.4	A30 Q-BF	80m/s
BE1216	400x4.0x25.4	A30 Q-BF	80m/s



Large Cut Off Wheel For Gasoline Power Saw

For Steel

Features

- Used for fixed cutting machine, 3.0mm thickness, offer users more durability, suitable for most high requirement customers.
- Maximize the friction and sharpness, reduce the burrs after cutting.
- Various cutting applications, increase side strength to ensure safer application.
- Has perfect abrasive performance and extra durability on application of steel.

Product advantages

- Superior Durability
- High break-resistance
- Economic
- Ultrahigh cutting speed
- Comfortable cutting experience
- No block



BINIC Article Nr.	Size(mm)	Specification	Speed
BE1207	300 x 3.0 x 22.23	A30 S-BF	80m/s
BE1208	300 x 3.0 x 25.4	A30 S-BF	80m/s
BE1209	350 x 3.5 x 22.23	A30 S-BF	80m/s
BE1210	350 x 3.5 x 25.40	A30 S-BF	80m/s

For Stone & Concrete

Features

- Used for petrol-driven machine 3.0mm thickness, offer users more durability, suitable for special application, as disaster relief and so on.
- Maximize the friction and sharpness.
- Various cutting applications, increase side strength to ensure safer application.
- Perfect abrasive performance and extra durability on application of steel.

Product advantages

- Superior Durability
- High break-resistance
- Economic
- Ultrahigh cutting speed
- Comfortable cutting experience
- No block



BINIC Article Nr.	Size(mm)	Specification	Speed
BE1211	300 x 3.0 x 22.23	C24 R-BF	80m/s
BE1212	300 x 4.0 x 20.0	C24 R-BF	80m/s
BE1213	350 x 4.0 x 20.0	C24 R-BF	80m/s
BE1213	350 x 4.0 x 22.23	C24 R-BF	80m/s

Tin Box Set



Metal Cutting



BINIC Article Nr.	Size(mm)	Shape	Specification	Application	Speed	R.P.M
BE1013	115x1.0x22.23	T41	A60 T-BF	G	80m/s	13300
BE1014	125x1.0x22.23	T41	A60 T-BF	G	80m/s	12200



Stainless Steel (INOX) Cutting



BINIC Article Nr.	Size(mm)	Shape	Specification	Application	Speed	R.P.M.
BE1017	115x1.0x22.23	T41	WA60 T-BF	Stainless Steel (INOX)	80m/s	13300
BE1018	125x1.0x22.23	T41	WA60 T-BF	Stainless Steel (INOX)	80m/s	12200

Stainless Steel (INOX) / Steel Cutting

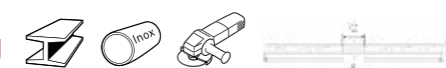

BINIC Article Nr.	Size(mm)	Shape	Specification	Application	Speed	R.P.M.
BE1015	115x1.0x22.23	T41	AS60 T-BF	SS/S	80m/s	13300
BE1016	125x1.0x22.23	T41	AS60 T-BF	SS/S	80m/s	12200



Tin box set

■ For disc 115mm and 125mm with thickness 0.8mm,10mm, can be piped in the shelf of tool supermarket.



Plastic Box Set











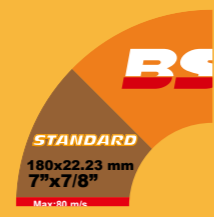

■ For disc 115mm with thickness 125mm and 0.8mm,1.0mm



FLAP DISC

Product Group

BSP offers four integrated product groups, For each user and application we offer the right flap disc. All flap disc are manufactured according to the applicable standards and guarantee the highest degree of safety.

Application	ECO	STANDARD	PROFESSIONAL	MAX
METAL		 <p>STANDARD 180x22.23 mm 7"x7/8" Max: 80 m/s</p>	 <p>PRO 180x22.23 mm 7"x7/8" Max: 80 m/s</p>	
Stainless Steel (INOX)	 <p>ECO 180x22.23 mm 7"x7/8" Max: 80 m/s</p>	 <p>STANDARD 180x22.23 mm 7"x7/8" Max: 80 m/s</p>	 <p>PRO 180x22.23 mm 7"x7/8" Max: 80 m/s</p>	
	 <p>ECO plus 180x22.23 mm 7"x7/8" Max: 80 m/s</p>	 <p>STANDARD plus 180x22.23 mm 7"x7/8" Max: 80 m/s</p>	 <p>PRO plus 180x22.23 mm 7"x7/8" Max: 80 m/s</p>	 <p>MAX 180x22.23 mm 7"x7/8" Max: 80 m/s</p>
STONE		 <p>STANDARD 180x22.23 mm 7"x7/8" Max: 80 m/s</p>	 <p>PRO 180x22.23 mm 7"x7/8" Max: 80 m/s</p>	
		 <p>STANDARD plus 180x22.23 mm 7"x7/8" Max: 80 m/s</p>	 <p>PRO plus 180x22.23 mm 7"x7/8" Max: 80 m/s</p>	

Flap Material

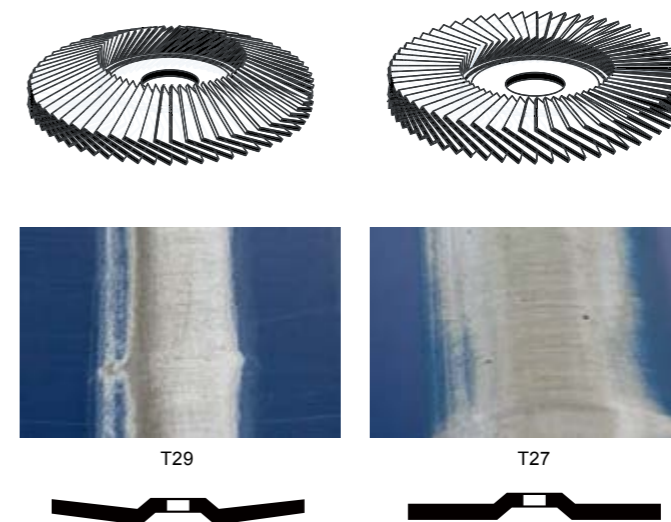
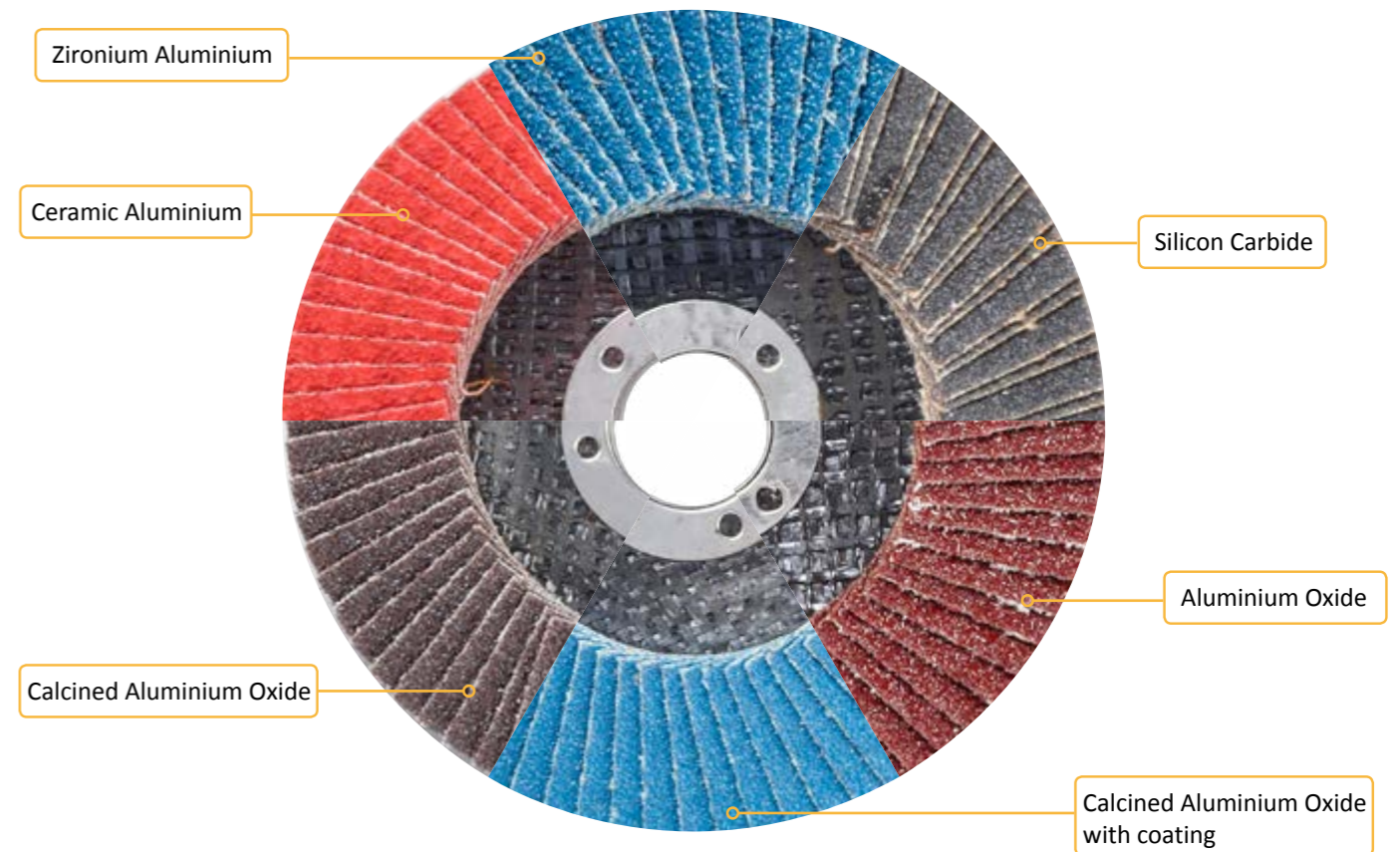

Label



Aluminium Oxide - Metal Grinding STANDARD

Features

- Mild steel, tool steels, plastic, primer, lacquers and wood.
- Cleaning of welding seams, deburring, chamfer, De-rust, preparatory works for lacquer of carbodies, machines, switch boards, tank constructions, sanding of wooden surface such as parquet for furniture.
- Flat and conical flap discs with fiberglass or plastic backing support.
- High performance, durable.



	Article Nr.	Inch	Metric(mm)	Type	Grit
Standard	BF1001	4"x5/8"	100x16	T27/29	A40-120#
	BF1002	4.5"x7/8"	115x22.2	T27/29	A40-120#
	BF1003	5"x7/8"	125x22.2	T27/29	A40-120#
	BF1004	6"x7/8"	150x22.2	T27/29	A40-120#
	BF1005	7"x7/8"	180x22.2	T27/29	A40-120#

STANDARD PLUS With Increased Flaps Number

Features

- Mild steel, tool steels, plastic, primer, lacquers and wood.
- Cleaning of welding seams, deburring, chamfer, De-rust, preparatory works for lacquer of carbodies, machines, switch boards, tank constructions, sanding of wooden surface such as parquet for furniture.
- Flat and conical flap discs with fiberglass or plastic backing support.
- High performance, durable.



	Article Nr.	Inch	Metric(mm)	Type	Grit
Standard Plus	BF1006	4"x5/8"	100x16	T27/29	A40-120#
	BF1007	4.5"x7/8"	115x22.2	T27/29	A40-120#
	BF1008	5"x7/8"	125x22.2	T27/29	A40-120#
	BF1009	6"x7/8"	150x22.2	T27/29	A40-120#
	BF1010	7"x7/8"	180x22.2	T27/29	A40-120#



Aluminium Oxide - Metal Grinding

PRO

Features

- High quality Aluminum Oxide grains.
- Strong fiberglass and X-weight cloth backing.
- T29 shape ideal for contour and edge work.
- T27 shape good for working on flat grinding surfaces.
- Available in High Density and Standard Density.
- Used on all ferrous and non-ferrous metals, aluminium for all purpose sanding and grinding, rust removal, light deburring.



Article Nr.	Inch	Metric(mm)	Type	Grit
BF1011	4"x5/8"	100x16	T27/29	A40-120#
BF1012	4.5"x7/8"	115x22.2	T27/29	A40-120#
BF1013	5"x7/8"	125x22.2	T27/29	A40-120#
BF1014	6"x7/8"	150x22.2	T27/29	A40-120#
BF1015	7"x7/8"	180x22.2	T27/29	A40-120#

PRO PLUS

With Increased Flaps Number

Features

- Ensures low build-up of heat in the workpiece even when used with minimum contact pressure on variable-speed angle grinders at low rotational speeds.
- Performs exceptionally well on sheet metal and thin profiles.
- Especially suited for use on stainless steel or cold rolled steels, aluminum oxide flap discs are self-lubricating to avoid over-heating of the work piece. The size coat and top size coat also aid reduced clogging and improve the resulting finish.
- Cool surface grinding, work on weld seams.



Article Nr.	Inch	Metric(mm)	Type	Grit
BF1016	4"x5/8"	100x16	T27/29	A40-120#
BF1017	4.5"x7/8"	115x22.2	T27/29	A40-120#
BF1018	5"x7/8"	125x22.2	T27/29	A40-120#
BF1019	6"x7/8"	150x22.2	T27/29	A40-120#
BF1020	7"x7/8"	180x22.2	T27/29	A40-120#

Zirconia Aluminium - Stainless Steel & Metal

ECO

Features

- Zirconia alumina is a high-performance abrasive delivering optimum stock removal performance on high-powered angle grinders at higher contact pressures.
- Premium zirconium grain on a durable polyester-cotton backing provides fast cutting action and long life.
- Work on steel, stainless steel(inox), weld seams, chamfering, surface grinding on steel.

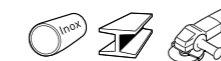

Article Nr.	Inch	Metric(mm)	Type	Grit
BF1021	4"x5/8"	100x16	T27/29	ZA40-120#
BF1022	4.5"x7/8"	115x22.2	T27/29	ZA40-120#
BF1023	5"x7/8"	125x22.2	T27/29	ZA40-120#
BF1024	6"x7/8"	150x22.2	T27/29	ZA40-120#
BF1025	7"x7/8"	180x22.2	T27/29	ZA40-120#

ECO PLUS

With Increased Flaps Number

Features

- The support of the abrasive band consists of a cotton twill which shows an outstanding removing rate and excellent lifetime - without clogging up.
- The glass fibre backing is characterised by an even grinding finish up to the complete consumption of the abrasive grain. As a result, no scratches on the workpiece will appear.
- Work on steel, stainless steel(inox), weld seams, chamfering, surface grinding on steel.



Article Nr.	Inch	Metric(mm)	Type	Grit
BF1026	4"x5/8"	100x16	T27/29	ZA40-120#
BF1027	4.5"x7/8"	115x22.2	T27/29	ZA40-120#
BF1028	5"x7/8"	125x22.2	T27/29	ZA40-120#
BF1029	6"x7/8"	150x22.2	T27/29	ZA40-120#
BF1030	7"x7/8"	180x22.2	T27/29	ZA40-120#

Zirconia Aluminium - Stainless Steel & Metal STANDARD

Features

- Fast grinding through constant grinding aggressiveness to the last abrasive grit
- Highest economic value through greater performance per time unit, less wear on the disc and reduced set-up times.
- The greatest possible stock removal
- For use on stainless steel, sheet metal, tool steels, heat-treated steels, and for the grinding & finishing of welds. For aggressive use on heavy duty applications.
- Extremely long tool life.
- Work on steel, stainless steel(inox),weld seams, chamfering,deburring.



Article Nr.	Inch	Metric(mm)	Type	Grit
BF1031	4"x5/8"	100x16	T27/29	ZA40-120#
BF1032	4.5"x7/8"	115x22.2	T27/29	ZA40-120#
BF1033	5"x7/8"	125x22.2	T27/29	ZA40-120#
BF1033	6"x7/8"	150x22.2	T27/29	ZA40-120#
BF1035	7"x7/8"	180x22.2	T27/29	ZA40-120#

STANDARD PLUS

With Increased Flaps Number

Features

- The support of the abrasive band consists of a cotton will which shows an outstanding removing rate and excellent lifetime - without clogging up!
- The glass fibre backing is characterised by an even grinding finish up to the complete consumption of the abrasive grain. As a result, no scratches on the workpiece will appear.
- Work on steel, stainless steel(inox),weld seams, chamfering,surface grinding on steel.



Article Nr.	Inch	Metric(mm)	Type	Grit
BF1036	4"x5/8"	100x16	T27/29	ZA40-120#
BF1037	4.5"x7/8"	115x22.2	T27/29	ZA40-120#
BF1038	5"x7/8"	125x22.2	T27/29	ZA40-120#
BF1039	6"x7/8"	150x22.2	T27/29	ZA40-120#
BF1040	7"x7/8"	180x22.2	T27/29	ZA40-120#

Zirconia Aluminium - Stainless Steel & Metal PRO

Features

- This abrasive grain is less hard, but very tough, and gives the disc very good all purpose characteristics.
- It is used for such demanding operations as deburring, machining welding seams and breaking edges.
- The glass fibre backing is characterised by an even grinding finish until all of the abrasive grain has been worn away.
- Leaves no scratches on the workpiece.
- Stainless steel, steel, cast



Article Nr.	Inch	Metric(mm)	Type	Grit
BF1041	4"x5/8"	100x16	T27/29	ZA40-120#
BF1042	4.5"x7/8"	115x22.2	T27/29	ZA40-120#
BF1043	5"x7/8"	125x22.2	T27/29	ZA40-120#
BF1044	6"x7/8"	150x22.2	T27/29	ZA40-120#
BF1045	7"x7/8"	180x22.2	T27/29	ZA40-120#

With VSM or 3M Flaps

PRO PLUS

With Increased Flaps Number

Features

- The pro plus flap disc is a high-end product for all users who recognise quality. Increased number of lamellas, even more aggressive material removal rate(steeper arrangement of lamellas) and still a higher lifetime than the AZ type.
- Improved tried-and-trusted topquality to optimize the efficiency of your tool.
- Mild steel and stainless steel. For grinding on edges as well as on surfaces.



Article Nr.	Inch	Metric(mm)	Type	Grit
BF1046	4"x5/8"	100x16	T27/29	ZA40-120#
BF1047	4.5"x7/8"	115x22.2	T27/29	ZA40-120#
BF1048	5"x7/8"	125x22.2	T27/29	ZA40-120#
BF1049	6"x7/8"	150x22.2	T27/29	ZA40-120#
BF1050	7"x7/8"	180x22.2	T27/29	ZA40-120#

With VSM or 3M Flaps

Silicon Carbide - Stone Grinding STANDARD

Features

- The standard silicon Carbide features an extremely tough Silicon Carbide abrasive grain.
- The silicon carbide disc is excellent for paint removal, blending/finishing, surface preparation, grinding and polishing.
- Used on marble, granite, stone, concrete.

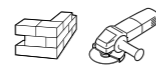

	Article Nr.	Inch	Metric(mm)	Type	Grit
Standard	BF1051	4"x5/8"	100x16	T27/29	C40-120#
	BF1052	4.5"x7/8"	115x22.2	T27/29	C40-120#
	BF1053	5"x7/8"	125x22.2	T27/29	C40-120#
	BF1054	6"x7/8"	150x22.2	T27/29	C40-120#
	BF1055	7"x7/8"	180x22.2	T27/29	C40-120#

Silicon Carbide - Stone Grinding PRO

Features

- Silicon carbide abrasive offers hardness and durability for use with titanium, fiberglass, plastic, and masonry.
- Provides a high-quality surface finish on hard-to-machine materials.
- Type 27 depressed center flap style is used for surface grinding, edge grinding, and removal of marks from concrete.
- Phenolic resin backing offers durability and reinforcement.
- Threaded hole for attachment to grinding tools.
- Use on marble, granite, stone, concrete.

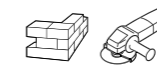

	Article Nr.	Inch	Metric(mm)	Type	Grit
Pro	BF1085	4"x5/8"	100x16	T27/29	C40-120#
	BF1086	4.5"x7/8"	115x22.2	T27/29	C40-120#
	BF1087	5"x7/8"	125x22.2	T27/29	C40-120#
	BF1088	6"x7/8"	150x22.2	T27/29	C40-120#
	BF1089	7"x7/8"	180x22.2	T27/29	C40-120#

STANDARD PLUS With Increased Flaps Number

Features

- Flap disc equipped with silicon carbide abrasive on a glass fibre backing.
- Good removal rate on various materials.
- Application: For working on concrete, stone, tiles, ceramics, non-ferrous metals.
- Used on marble, granite, stone, concrete.



	Article Nr.	Inch	Metric(mm)	Type	Grit
Standard Plus	BF1056	4"x5/8"	100x16	T27/29	C40-120#
	BF1057	4.5"x7/8"	115x22.2	T27/29	C40-120#
	BF1058	5"x7/8"	125x22.2	T27/29	C40-120#
	BF1059	6"x7/8"	150x22.2	T27/29	C40-120#
	BF1060	7"x7/8"	180x22.2	T27/29	C40-120#

PRO PLUS With Increased Flaps Number

Features

- Sharp cut, excellent for finishing concrete, stone, fiberglass and other nonferrous materials (brass, bronze, aluminum, etc.) Excellent for both blending and finishing.
- High strength, lightweight, absorbs vibration.
- Ideal for end-users unable to measure performance.
- Used on marble, granite, stone, concrete for working on surfaces.



	Article Nr.	Inch	Metric(mm)	Type	Grit
Stainless Steel (INOX) ECO Plus	BF1090	4"x5/8"	100x16	T27/29	C40-120#
	BF1091	4.5"x7/8"	115x22.2	T27/29	C40-120#
	BF1092	5"x7/8"	125x22.2	T27/29	C40-120#
	BF1093	6"x7/8"	150x22.2	T27/29	C40-120#
	BF1094	7"x7/8"	180x22.2	T27/29	C40-120#

Ceramic Aluminium Oxide Stainless Steel & Metal

Max

Features

- Significantly improves life, grain retention and fray resistance.
- Cool, noticeably fast cut rate.
- Produced with new technique raw material, stable and extremely high efficiency.
- Very aggressive and consistent, New resin system for high grain retention cut rate Maximum contact with workpiece without loading.
- Fine finishing primarily on flat surfaces.
- Last 50% – 200% longer than any flap discs on stainless steel, cobalt, chrome, Inconel, titanium and other hard-to-grind materials.

Product advantages

- Overlong durability
- High cutting speed
- Comfortable grinding experience
- Burr-free
- Sharp



	Article Nr.	Inch	Metric(mm)	Type	Grit
Stainless Steel (INOX) Max	BF1061	4"x5/8"	100x16	T27/29	CA40-120#
	BF1062	4.5"x7/8"	115x22.2	T27/29	CA40-120#
	BF1063	5"x7/8"	125x22.2	T27/29	CA40-120#
	BF1064	6"x7/8"	150x22.2	T27/29	CA40-120#
	BF1065	7"x7/8"	180x22.2	T27/29	CA40-120#



2 in 1- Calcined Alumina Stainless Steel & Metal

PRO

Features

- Mild steel, tool steels, plastic, primer, lacquers and wood
- Cleaning of welding seams, deburring, chamfer, De-rust, preparatory works for lacquer of carbodies, machines, switch boards, tank constructions, sanding of wooden surface such as parquet for furniture.
- Flat and conical flap discs with fiberglass or plastic backing support.
- High performance, durable.



	Article Nr.	Inch	Metric(mm)	Type	Grit
Pro	BF1066	4"x5/8"	100x16	T27/29	A40-120#
	BF1067	4.5"x7/8"	115x22.2	T27/29	A40-120#
	BF1068	5"x7/8"	125x22.2	T27/29	A40-120#
	BF1069	6"x7/8"	150x22.2	T27/29	A40-120#
	BF1070	7"x7/8"	180x22.2	T27/29	A40-120#

PRO PLUS

With Increased Flaps Number

Features

- Mild steel, tool steels, plastic, primer, lacquers and wood.
- Cleaning of welding seams, deburring, chamfer, De-rust, preparatory works for lacquer of carbodies, machines, switch boards, tank constructions, sanding of wooden surface such as parquet for furniture.
- Flat and conical flap discs with fiberglass or plastic backing support.
- High performance, durable.



	Article Nr.	Inch	Metric(mm)	Type	Grit
Pro Plus	BF1071	4"x5/8"	100x16	T27/29	A40-120#
	BF1072	4.5"x7/8"	115x22.2	T27/29	A40-120#
	BF1073	5"x7/8"	125x22.2	T27/29	A40-120#
	BF1074	6"x7/8"	150x22.2	T27/29	A40-120#
	BF1075	7"x7/8"	180x22.2	T27/29	A40-120#



Plastic Backing Flap Disc

Zirconia-Stainless Steel

STANDARD

Features

- Cleaning of welding seams, deburring, chamfer, De-rust, preparatory works for lacquer of carbodies, machines, switch boards, tank constructions, sanding of wooden surface such as parquet for furniture
- Flat and conical flap discs with fiberglass or plastic backing support.
- High performance, durable.



	Article Nr.	Inch	Metric(mm)	Type	Grit
Stainless Steel (INOX) Standard	BF1076	4.5"x7/8"	115x22.2	T27	ZA40-120#
	BF1077	7"x7/8"	180x22.2v	T27	ZA40-120#



Plastic Backing Flap Disc

Ceramic Corundum - Stainless Steel



STANDARD - A

Features

- Cleaning of welding seams, deburring, chamfer, De-rust, preparatory works for lacquer of carbodies, machines, switch boards, tank constructions, sanding of wooden surface such as parquet for furniture.
- Flat and conical flap discs with fiberglass or plastic backing support.
- High performance, durable.



	Article Nr.	Inch	Metric(mm)	Type	Grit
Stainless Steel (INOX) Standard	BF1078	4.5"x7/8"	115x22.2	T27	ZA40-120#
	BF1079	7"x7/8"	180x22.2	T27	ZA40-120#
	BF1080	4.5"x7/8"	115x5/8-11	T27	ZA40-120#
	BF1081	4.5"x7/8"	115xM14	T27	ZA40-120#



STANDARD - B

Features

- Cleaning of welding seams, deburring, chamfer, De-rust, preparatory works for lacquer of carbodies, machines, switch boards, tank constructions, sanding of wooden surface such as parquet for furniture.
- Flat and conical flap discs with fiberglass or plastic backing support.
- High performance, durable.



	Article Nr.	Inch	Metric(mm)	Type	Grit
Stainless Steel (INOX) Standard	BF1082	4"xM10	100xM10	T27	ZA40-120#
	BF1083	4.5"x5/8-11	115x5/8-11	T27	ZA40-120#
	BF1084	5"xM14	125xM14	T27	ZA40-120#



WIRE BRUSH

Technical Information

Working speed & maximum safe free speeds

Surface speeds in metres per se c.

On each tool you can find the maximum safety turning speed. This speed is important to ensure your safety at work and must not be exceeded. Using angle grinders with an adjustable turning speed allows you to adjust their turning speed to the maximum allowed.

		Brush diameter (in mm)											
min ⁻¹	20	40	50	80	100	125	150	180	200	250	300	350	
800				3.35	4.19	5.23	6.28	7.53	8.37	10.47	12.56	14.75	
900			2.35	3.77	4.71	5.88	7.06	8.48	9.41	11.77	14.12	16.47	
1,150			3.01	4.81	6.01	7.52	9.02	10.83	12.03	15.04	18.04	21.04	
1,200	1.26	2.51	3.14	5.02	6.28	7.85	9.41	11.30	12.55	15.69	18.83	21.97	
1,400	1.46	2.93	3.66	5.86	7.32	9.15	10.98	13.18	14.64	18.31	21.97	25.63	
1,500	1.57	3.14	3.92	6.28	7.85	9.81	11.77	14.13	15.69	19.61	23.54	27.46	
1,800	1.88	3.77	4.71	7.54	9.41	11.77	14.12	16.95	18.83	23.54	28.24	32.95	
2,000	2.09	4.19	5.23	8.37	10.26	13.08	15.69	18.84	20.92	26.15	31.38	36.61	
2,500	2.62	5.23	6.54	10.47	13.08	16.35	19.61	23.55	26.15	32.67	39.23	45.76	
2,800	2.93	5.86	7.32	11.72	14.64	18.31	21.97	26.37	29.29	36.61	43.93	51.25	
3,000	3.14	6.28	7.85	12.56	15.69	19.62	23.54	28.26	31.38	39.23	47.07	54.92	
3,200	3.35	6.70	8.37	13.40	16.74	20.92	25.10	30.14	33.47	41.84	50.21	58.58	
3,500	3.66	7.33	9.15	14.65	18.31	22.89	27.46	32.97	36.61	45.76	54.92	64.07	
4,000	4.19	8.37	10.46	16.75	20.92	26.16	31.38	37.68	41.84	52.33	62.76	73.22	
4,500	4.70	9.42	11.77	18.84	23.54	29.43	35.30	42.40	47.07	58.84	70.61	82.43	
5,000	5.23	10.47	13.08	20.93	26.15	32.70	39.23	47.10	52.33	65.38	78.50		
5,400	5.65	11.30	14.12	22.94	28.24	35.31	42.36	50.67	56.48	70.61	84.78		
6,000	6.28	12.56	15.69	25.12	31.38	39.24	47.07	56.62	62.76	78.50			
7,000	7.33	14.66	18.31	29.31	36.61	45.78	54.92	65.94	73.22	91.58			
8,000	8.37	16.75	20.92	33.94	41.48	52.32	62.76	75.36	83.73				
9,000	9.42	18.84	23.54	37.88	47.07	58.86	70.61	84.78	94.20				
10,000	10.47	20.93	26.17	41.86	52.33	65.40	78.50	94.20					
12,500	13.08	26.17	32.71	52.33	65.42	81.75	98.13						
15,000	15.70	31.40	39.25	62.80									
17,500	18.32	36.63	45.79	73.26									
20,000	20.93	41.87	52.33	83.75									
22,500	23.55	47.10	58.88	94.20									
25,000	26.17	52.33	65.42	104.66									

Standard values:
for crimped wire 30–35 m/sec
for nylon bristle 18–22 m/sec

Recommended brush diameters for angle grinders

		Brush diameter (in mm)											
Ø	Machine outside diameter	60	65	75	80	90	100	115	120	125	150	175	
Wheel brush, knotted							115	115		125	150	180	
Wheel brush, crimped							115	115					
Cup brush, knotted			115	125	150		180						
Cup brush, crimped		115		125	150		180						
Cup brush, abrasive								adjustable					
								150					

Working speed for Ø:

■ Ø 115 mm (4 1/2") 12.500 U/min⁻¹

■ Ø 125 mm (5") 11.000 U/min⁻¹

■ Ø 150 mm (6") 8.500 U/min⁻¹

■ Ø 180 mm (7") 8.500 U/min⁻¹

■ Ø 230 mm (9") 6.500 U/min⁻¹

WIRE BRUSH

Wires



S

Soft

B-Brass Wire

Straight crimped diameter 0.06mm to 0.50mm



SS

Medium

S-Steel wire

Natural hard, crimped, diameter 0.06mm to 0.80mm



S-T

BS-Brass coated steel wire

Single wire, springy, crimped or straight. Diameter 0.15mm to 0.38mm



BS

SS-Stainless steel wire

Acid resistant, crimped or straight. Dia. 0.15mm to 1.0mm.

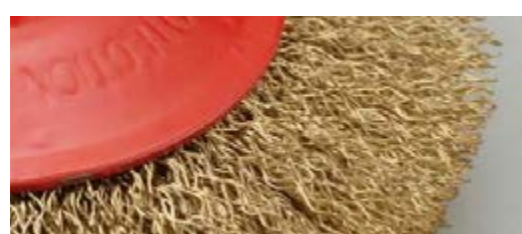

B

Hard

ST-Steel wire

Tempered straight. Diameter 0.3mm to 1.2mm



Crimped Wire Cup Brushes



Features:

- The brushes are ideally suited for use on stationary machines, pneumatic grinders and electric tools.
- We supply them with a threaded or plain arbor hole to suite your machines.

Fill type:

- S-Steel wire
- BS-brass coated steel wire
- SS-stainless steel wire
- B-Brass wire

Application:

- Cleaning prior to welding, rust and paint removal, weld spatter, and corrosion removal surface ships, metal surface, light and medium duty cleaning.



Article Nr.	Diameter (Metric)	Diameter (Inch)	Inner diameter	Fill types (mm)				RPM
				S	BS	B	SS	
BB1001	65mm	2-1/2"	16,M10x1.25,M10x1.5,M14x2,5/8"-11UNC	0.30/0.35	0.30/0.35	0.30/0.35	0.30/0.35	12500
BB1002	75mm	3"	22.2,M10x1.25,M10x1.5,M14x2,5/8"-11UNC	0.30/0.35	0.30/0.35	0.30/0.35	0.30/0.35	12500
BB1003	90mm	3-1/2"	22.2,M14x2,5/8"-11UNC	0.30/0.35	0.30/0.35	0.30/0.35	0.30/0.35	8500
BB1004	100mm	4"	22.2,M14x2,5/8"-11UNC	0.30/0.35	0.30/0.35	0.30/0.35	0.30/0.35	8500
BB1005	125mm	5"	22.2,M14x2,5/8"-11UNC	0.30/0.35	0.30/0.35	0.30/0.35	0.30/0.35	6500
BB1006	150mm	6"	22.2,M14x2,5/8"-11UNC	0.30/0.35	0.30/0.35	0.30/0.35	0.30/0.35	6500

Twisted Knot Bowl Cup Brushes



Features:

- The support ring of this special design prevents excessive spreading of the fill material.
- This is especially useful when deburring flat surfaces, since a greater number of bristle tips then act on the workpiece.
- The TS-Special when used with an orbital action will make short work of all burrs.

Fill type:

- ST-Steel wire
- SS-stainless steel wire

Application:

- Heavy duty, cleaning of large metal surface, weld scale and corrosion removal.
- Pre-paint surface preparation.
- Ideal for cleaning welds and fabricated steelworks.



Article Nr.	Diameter (Metric)	Diameter (Inch)	Inner diameter	Fill types (mm)		RPM
				ST	SS	
BB1007	65mm	2-1/2"	16, M10x1.25, M10x1.5, M14x2, 5/8"-11UNC	0.35/0.50	0.35/0.50	12500
BB1008	75mm	3"	22.2, M10x1.25, M10x1.5, M14x2, 5/8"-11UNC	0.35/0.50	0.35/0.50	12500
BB1009	90mm	3-1/2"	22.2, M14x2, 5/8"-11UNC	0.35/0.50	0.35/0.50	8500
BB1010	100mm	4"	22.2, M14x2, 5/8"-11UNC	0.35/0.50	0.35/0.50	8500
BB1011	125mm	5"	22.2, M14x2, 5/8"-11UNC	0.35/0.50	0.35/0.50	6500
BB1012	150mm	6"	22.2, M14x2, 5/8"-11UNC	0.35/0.50	0.35/0.50	6500

Twisted Knot Bowl Cup Brushes Double Row



Features:

- The support ring of this special design prevents excessive spreading of the fill material.
- This is especially useful when deburring flat surfaces, since a greater number of bristle tips then act on the workpiece.
- The TS-Special when used with an orbital action will make short work of all burrs.

Fill type:

- ST-Steel wire
- SS-stainless steel wire

Application:

- Heavy duty, cleaning of large metal surface, weld scale and corrosion removal.
- Pre-paint surface preparation.
- Ideal for cleaning welds and fabricated steelworks.



Article Nr.	Diameter (Metric)	Diameter (Inch)	Inner diameter	Fill types (mm)		RPM
				ST	SS	
BB1013	100mm	4"	22.2, M14x2, 5/8"-11UNC	0.35/0.50	0.35/0.50	8500
BB1014	125mm	5"	22.2, M14x2, 5/8"-11UNC	0.35/0.50	0.35/0.50	6500
BB1015	150mm	6"	22.2, M14x2, 5/8"-11UNC	0.35/0.50	0.35/0.50	6500

Twisted Knot Cup Brushes



Features:

- Heavy duty and efficiently on a variety of cleaning.
- The steel supported rings reduce the wire flare and have more aggressive effect

Fill type:

- ST-Steel wire
- SS-stainless steel wire

Application:

- For heavy-duty use such as the removal of paint, scale, corrosion of all kinds and the cleaning of all kinds and cleaning of weld seams and spot-welds.
- Single twists, oil-hardened wire-the features with give these brushes their aggressive action.



Article Nr.	Diameter (Metric)	Diameter (Inch)	Inner diameter	Fill types (mm)		RPM
				ST	SS	
BB1016	65mm	2-1/2"	16,M10x1.25,M10x-1.5,M14x2,5/8"-11UNC	0.35/0.50	0.35/0.50	12500
BB1017	75mm	3"	22.2,M10x1.25,M10x-1.5,M14x2,5/8"-11UNC	0.35/0.50/0.80	0.35/0.50	12500
BB1018	80mm	3-1/8"	22.2,M10x1.25,M10x-1.5,M14x2,5/8"-11UNC	0.35/0.50/0.80	0.35/0.50	8500
BB1019	90mm	3-1/2"	22.2,M14x2,5/8"-11UNC	0.35/0.50/0.80	0.35/0.50	8500
BB1020	100mm	4"	22.2,M14x2,5/8"-11UNC	0.35/0.50/0.80	0.35/0.50	8500
BB1021	125mm	5"	22.2,M14x2,5/8"-11UNC	0.35/0.50/0.80	0.35/0.50	6500

Crimped Wire Bevel Brushes



Fill type:

- S-Steel wire
- BS-brass coated steel wire
- SS-stainless steel wire
- B-Brass wire

Application:

- Heavy/duty work such as the removal of paint, scale and corrosion of all kinds.
- Design particularly suitable for work on internal corners, using a one-hand and large angle ginder.



Article Nr.	Diameter (Metric)	Diameter (Inch)	Inner diameter	Fill types (mm)				RPM
				S	BS	B	SS	
BB1026	85mm	3-11/32"	M10x1.25,M10x-1.5,M14x2,5/8"-11UNC	0.20/0.30/0.35	0.30/0.35	0.30/0.35	0.30/0.35	12500
BB1027	100mm	4"	M10x1.25,M10x-1.5,M14x2,5/8"-11UNC	0.20/0.30/0.35	0.30/0.35	0.30/0.35	0.30/0.35	12500
BB1028	115mm	4-1/2"	M14x2,5/8"-11UNC	0.20/0.30/0.35	0.30/0.35	0.30/0.35	0.30/0.35	12500
BB1029	125mm	5"	M14x2,5/8"-11UNC	0.20/0.30/0.35	0.30/0.35	0.30/0.35	0.30/0.35	12500

Twisted Knot Cup Brushes

Features:

- Heavy duty and efficiently on a variety of cleaning.
- The steel supported rings reduce the wire flare and have more aggressive effect

Fill type:

- ST-Steel wire
- SS-stainless steel wire

Application:

- For heavy-duty use such as the removal of paint, scale, corrosion of all kinds and the cleaning of all kinds and cleaning of weld seams and spot-welds.
- Single twists, oil-hardened wire-the features with give these brushes their aggressive action.



Article Nr.	Diameter (Metric)	Diameter (Inch)	Inner diameter	Fill types (mm)		RPM
				ST	SS	
BB1022	75mm	3"	22.2,M10x1.25,M10x-1.5,M14x2,5/8"-11UNC	0.35/0.50	0.35/0.50	12500
BB1023	90mm	3-1/2"	22.2,M14x2,5/8"-11UNC	0.35/0.50	0.35/0.50	8500
BB1024	100mm	4"	22.2,M14x2,5/8"-11UNC	0.35/0.50	0.35/0.50	8500
BB1025	125mm	5"	22.2,M14x2,5/8"-11UNC	0.35/0.50	0.35/0.50	6500

Twisted Knot Bevel Brushes

Fill type:

- ST-Steel wire
- SS-stainless steel wire

Application:

- Heavy/duty work such as the removal of paint, scale and corrosion of all kinds.
- Design particularly suitable for work on internal corners, using a one-hand and large angle ginder.



Article Nr.	Diameter (Metric)	Diameter (Inch)	Inner diameter	Fill types (mm)		RPM
				ST	SS	
BB1030	100mm	4"	M10x1.25,M10x-1.5,M14x2,5/8"-11UNC	0.35/0.50	0.35/0.50	12500
BB1031	115mm	4-1/2"	M14x2,5/8"-11UNC	0.35/0.50	0.35/0.50	12500

Twisted Knot Wheel Brushes With Thread Standard Twist



Fill type:

- ST-Steel wire
- SS-stainless steel wire
- Oil Tempered Wires are available

Application:

- Removing excess rubber from rubber to metal bonded parts.
- Removing residues of adhesive, hard scale rust and paint. Cleaning welds.
- For use on angle grinder.



Article Nr.	Diameter (Metric)	Diameter (Inch)	Inner diameter	NO. of Wire	Fill types (mm)		RPM
					ST	SS	
BB1032	100mm	4"	M10x1.25,M10x1.5,M14x2,5/8"-11UNC	11	0.35/0.50	0.35/0.50	12500
BB1033	115mm	4-1/2"	M14x2,5/8"-11UNC	11	0.35/0.50	0.35/0.50	12500
BB1034	125mm	5"	M14x2,5/8"-11UNC	11	0.35/0.50	0.35/0.50	12500
BB1035	150mm	6"	M14x2,5/8"-11UNC	12	0.35/0.50	0.35/0.50	9000
BB1036	180mm	7"	M14x2,5/8"-11UNC	15	0.35/0.50	0.35/0.50	9000
BB1037	230mm	9"	M14x2,5/8"-11UNC	15	0.35/0.50	0.35/0.50	8500

Thin Twisted Knot Wheel Brushes With Thread Standard Twist



Fill type:

- ST-Steel wire
- SS-stainless steel wire
- Oil Tempered Wires are available

Application:

- Thin wires are good for cleaning root and hot passes and reaching into corner.
- Widely used for welding industry.



Article Nr.	Diameter (Metric)	Diameter (Inch)	Inner diameter	Wire Thickness	NO. of Wire	Fill types (mm)		RPM
						ST	SS	
BB1038	100mm	4"	M10x1.25,M10x1.5,M14x2,5/8"-11UNC	6	30	0.35/0.50	0.35/0.50	12500
BB1039	115mm	4-1/2"	M14x2,5/8"-11UNC	6	30	0.35/0.50	0.35/0.50	12500
BB1040	150mm	6"	M14x2,5/8"-11UNC	6	52	0.35/0.50	0.35/0.50	9000
BB1041	180mm	7"	M14x2,5/8"-11UNC	6	52	0.35/0.50	0.35/0.50	9000
BB1042	230mm	9"	M14x2,5/8"-11UNC	6	56	0.35/0.50	0.35/0.50	8500

Twisted knot Wheel Brushes With Holes Stringer Bead



Fill type:

- ST-Steel wire
- SS-stainless steel wire
- Oil Tempered Wires are available

Application:

- Removing excess rubber from rubber to metal bonded parts.
- Removing residues of adhesive, hard scale rust and paint. Cleaning welds.
- For use on bench or handheld machines.



Article Nr.	Diameter (Metric)	Diameter (Inch)	Inner diameter	Wire Thicknes	NO. of Wire	Fill types (mm)		RPM
						ST	SS	
BB1043	75mm	3"	12.7	11	15	0.35/0.50	0.35/0.50	12500
BB1044	100mm	4"	22.2	11	18	0.35/0.50	0.35/0.50	12500
BB1045	115mm	4-1/2"	22.2	11	20	0.35/0.50	0.35/0.50	12500
BB1046	125mm	5"	22.2	11	22	0.35/0.50	0.35/0.50	12500
BB1047	150mm	6"	22.2	11	24	0.35/0.50	0.35/0.50	9000
BB1048	180mm	7"	22.2	11	28	0.35/0.50	0.35/0.50	9000
BB1049	230mm	9"	22.2	11	34	0.35/0.50	0.35/0.50	8500
BB1050	250mm	10"	22.2	11	54	0.35/0.50	0.35/0.50	4500
BB1051	300mm	12"	22.2	11	54	0.35/0.50	0.35/0.50	3600

Thin Twisted Knot Wheel Brushes With Holes Stringer Bead



Fill type:

- ST-Steel wire
- SS-stainless steel wire
- Oil Tempered Wires are available

Application:

- Thin wires are good for cleaning root and hot passes and reaching into corner.
- Widely used for welding industry.



Article Nr.	Diameter (Metric)	Diameter (Inch)	Inner diameter	Wire Thicknes	NO. of Wire	Fill types (mm)		RPM
						ST	SS	
BB1061	100mm	4"	16	6	30	0.35/0.50	0.35/0.50	12500
BB1062	115mm	4-1/2"	22.2	6	30	0.35/0.50	0.35/0.50	12500
BB1063	125mm	5"	22.2	6	40	0.35/0.50	0.35/0.50	12500
BB1064	150mm	6"	22.2	6	52	0.35/0.50	0.35/0.50	9000
BB1065	180mm	7"	22.2	6	52	0.35/0.50	0.35/0.50	9000
BB1066	230mm	9"	22.2	6	56	0.35/0.50	0.35/0.50	8500

Twisted Knot Wheel Brushes Double Rows Standard Twist



Features:

- More knot wire section
- Rows are available
- Loose wire type is available

Fill type:

- ST-Steel wire
- SS-stainless steel wire
- Oil Tempered Wires are available

Application:

- Removing excess rubber from rubber to metal bonded parts.
- Removing residues of adhesive, hard scale rust and paint, cleaning welds.



Article Nr.	Diameter (Metric)	Diameter (Inch)	Inner diameter	Wire Thickness	NO. of Wire	ST	RPM
BB1067	100mm	4"	16	19	22	0.35/0.50	12500
BB1068	125mm	5"	22.2	20	25	0.35/0.50	12500
BB1069	150mm	6"	22.2	22	28	0.35/0.50	9000
BB1070	230mm	9"	25.4	25	38	0.35/0.50	8500
BB1071	250mm	10"	25.4	32	52	0.35/0.50	4500
BB1072	300mm	12"	25.4	35	52	0.35/0.50	3600

Circular Brushes For Bench Wheel

Fill type:

- S-Steel wire

Application:

- Removing paint and other coating, including rust and scale from all types of steel work pieces and oxide layers from Stainless steel or non-ferrous metals.
- Creating metallically clean surfaces.
- Cleaning tool dies.
- Deburring casting.
- Matt finishing of metal surfaces.



Article Nr.	Diameter (Metric)	Diameter (Inch)	Wire Thickness	Inner diameter	S	RPM
BB1073	100mm	4"	16	M14x2,5/8"-11UNC	0.35	6000
BB1074	115mm	4-1/2"	16	M14x2,5/8"-11UNC	0.35	6000

Circular Brushes For Bench Wheel



Fill type:

- S-Steel wire
- BS-brass coated steel wire
- SS-stainless steel wire

Application:

- Removing paint and other coating, including rust and scale from all types of steel work pieces and oxide layers from Stainless steel or non-ferrous metals.
- Creating metallically clean surfaces.
- Cleaning tool dies.
- Deburring casting.
- Matt finishing of metal surfaces.



Article Nr.	Diameter (Metric)	Diameter (Inch)	Wire Thickness	Inner diameter	Fill types (mm)			RPM
					S	BS	SS	
BB1075	75mm	3"	17	20	0.30/0.35	0.30/0.35	0.30/0.35	8000
BB1076	100mm	4"	19	20	0.30/0.35	0.30/0.35	0.30/0.35	8000
BB1077	125mm	5"	25	20	0.30/0.35	0.30/0.35	0.30/0.35	6000
BB1078	150mm	6"	20	20	0.30/0.35	0.30/0.35	0.30/0.35	6000
BB1079	150mm	6"	25	32	0.30/0.35	0.30/0.35	0.30/0.35	6000
BB1080	180mm	7"	20	32	0.30/0.35	0.30/0.35	0.30/0.35	6000
BB1081	180mm	7"	25	32	0.30/0.35	0.30/0.35	0.30/0.35	6000
BB1082	230mm	9"	20	32	0.30/0.35	0.30/0.35	0.30/0.35	4500
BB1083	230mm	9"	25	32	0.30/0.35	0.30/0.35	0.30/0.35	4500
BB1084	250mm	10"	25	32	0.30/0.35	0.30/0.35	0.30/0.35	3600
BB1085	300mm	12"	30	32	0.30/0.35	0.30/0.35	0.30/0.35	3000

Circular Brush



Fill type:

- S-Steel wire
- BS-brass coated steel wire
- SS-stainless steel wire

Application:

- Applications include rust and paint removal, deburring, descaling, matt finishing and.



Article Nr.	Diameter (Metric)	Diameter (Inch)	Wire Thickness	Inner diameter	Fill types (mm)		RPM
					S	BS	
BB1086	75mm	3"	9	12.7	0.2/0.3/0.35	0.2/0.3/0.35	4500
BB1087	100mm	4"	12	12.7	0.2/0.3/0.35	0.2/0.3/0.35	4500
BB1088	125mm	5"	14	12.7	0.2/0.3/0.35	0.2/0.3/0.35	4500
BB1089	150mm	6"	14	16	0.2/0.3/0.35	0.2/0.3/0.35	4500
BB1090	180mm	7"	15	16	0.2/0.3/0.35	0.2/0.3/0.35	4500
BB1091	230mm	9"	15	16	0.2/0.3/0.35	0.2/0.3/0.35	3750
BB1092	250mm	10"	18	16	0.2/0.3/0.35	0.2/0.3/0.35	3750
BB1093	300mm	12"	18	16	0.2/0.3/0.35	0.2/0.3/0.35	3750

Article Nr.	Diameter (Metric)	Diameter (Inch)	Wire Thickness	Inner diameter	Fill types (mm)			RPM
					S	BS	SS	
BB1094	150mm	6"	20	50	0.30/0.35	0.30/0.35	0.30/0.35	6000
BB1095	150mm	6"	25	50	0.30/0.35	0.30/0.35	0.30/0.35	6000
BB1096	180mm	7"	20	50	0.30/0.35	0.30/0.35	0.30/0.35	6000
BB1097	180mm	7"	25	50	0.30/0.35	0.30/0.35	0.30/0.35	6000
BB1098	230mm	9"	20	50	0.30/0.35	0.30/0.35	0.30/0.35	4500
BB1099	230mm	9"	25	50	0.30/0.35	0.30/0.35	0.30/0.35	4500
BB1100	250mm	10"	25	50	0.30/0.35	0.30/0.35	0.30/0.35	3600
BB1101	300mm	12"	30	50	0.30/0.35	0.30/0.35	0.30/0.35	3000



Fill type:

- S-Steel wire
- BS-brass coated steel wire
- SS-stainless steel wire

Application:

- Creating metallicly clean surfaces.
- Cleaning tool dies.
- Deburring casting.
- Matt finishing of metal surfaces.



Shaft Mounted Cup Brushes

Shaft Mounted Cup Brushes Crimped Wire



Fill type:

- S-Steel wire
- BS-brass coated steel wire
- SS-stainless steel wire
- B-Brass wire

Application:

- Cup brushes with shaft are small diameter brushes and good to be used for drill machines. Normally the RPM is 4500. It's good for home work and do-it-yourself works. We have inch size and metric size for your choose. It's very flexible and most popular in use.

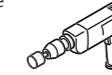

Article Nr.	Diameter (Metric)	Diameter (Inch)	Shank diameter	Fill types (mm)			RPM
				S	BS	SS	
BB1125	38mm	1-1/2"	6	0.2/0.3/0.35	0.2/0.3/0.35	0.2/0.3/0.35	4500
BB1126	50mm	2"	6	0.2/0.3/0.35	0.2/0.3/0.35	0.2/0.3/0.35	4500
BB1127	63mm	2-1/2"	6	0.2/0.3/0.35	0.2/0.3/0.35	0.2/0.3/0.35	4500
BB1128	75mm	3"	6	0.2/0.3/0.35	0.2/0.3/0.35	0.2/0.3/0.35	4500
BB1129	80mm	3-1/8"	6	0.2/0.3/0.35	0.2/0.3/0.35	0.2/0.3/0.35	4500
BB1130	100mm	4"	6	0.2/0.3/0.35	0.2/0.3/0.35	0.2/0.3/0.35	4500

Shaft Mounted Cup Brushes

1/4" Hex Shaft Mounted Cup Brushes Crimped Wire

Fill type:

- S-Steel wire
- BS-brass coated steel wire
- SS-stainless steel wire
- B-Brass wire

Application:

- Quick change shaft makes the brushes loaded on the drill machines conveniently and safety. Cup brushes with shaft are very flexible in surface cleaning.

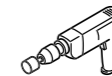

Article Nr.	Diameter (Metric)	Diameter (Inch)	Shank diameter	Fill types (mm)			RPM
				S	BS	SS	
BB1131	50mm	2"	6.35	0.2/0.3	0.2/0.3	0.2	4500
BB1132	75mm	3"	6.35	0.2/0.3	0.2/0.3	0.2	4500



Shaft Mounted Cup Brushes

Shaft Mounted Circular Brushes Crimped Wire



Fill type:

- S-Steel wire
- BS-brass coated steel wire
- SS-stainless steel wire
- B-Brass wire

Application:

- Quick change shaft makes the brushes loaded on the drill machines conveniently and safety. Wheel brushes with shaft are very flexible in use for surface cleaning.

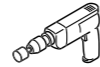

Article Nr.	Diameter (Metric)	Diameter (Inch)	Shank diameter	Fill types (mm)			RPM
				S	BS	SS	
BB1133	38mm	1-1/2"	6	0.2/0.3/0.35	0.2/0.3/0.35	0.2/0.3/0.35	6000
BB1134	50mm	2"	6	0.2/0.3/0.35	0.2/0.3/0.35	0.2/0.3/0.35	4500
BB1135	63mm	2-1/2"	6	0.2/0.3/0.35	0.2/0.3/0.35	0.2/0.3/0.35	4500
BB1136	75mm	3"	6	0.2/0.3/0.35	0.2/0.3/0.35	0.2/0.3/0.35	4500
BB1136	100mm	4"	6	0.2/0.3/0.35	0.2/0.3/0.35	0.2/0.3/0.35	4500

1/4" Hex Shaft Mounted Circular Brushes Crimped Wire



Fill type:

- S-Steel wire
- BS-brass coated steel wire
- SS-stainless steel wire
- B-Brass wire

Application:

- Quick change shaft makes the brushes loaded on the drill machines conveniently and safety. Wheel brushes with shaft are very flexible in use for surface cleaning.

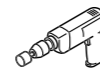

Article Nr.	Diameter (Metric)	Diameter (Inch)	Shank diameter	Fill types (mm)		RPM
				S	BS	
BB1138	50mm	2"	6.35	0.2/0.3	0.2/0.3	4500
BB1139	75mm	3"	6.35	0.2/0.3	0.2/0.3	4500
BB1140	100mm	4"	6.35	0.2/0.3	0.2/0.3	4500

Shaft Mounted Cup Brushes

Shaft Mounted End Brushes Crimped Wire



Fill type:

- S-Steel wire
- BS-brass coated steel wire
- SS-stainless steel wire
- B-Brass wire

Application:

- Very flexible in use. It's good to clean the corners and awkward areas.

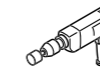

Article Nr.	Diameter (Metric)	Diameter (Inch)	Shank diameter	Fill types (mm)				RPM
				S	BS	B	SS	
BB1141	12mm	15/32"	6	0.30/0.35	0.30/0.35	0.30/0.35	0.30/0.35	4500
BB1142	15mm	15/32"	6	0.30/0.35	0.30/0.35	0.30/0.35	0.30/0.35	4500
BB1143	19mm	49/64"	6	0.30/0.35	0.30/0.35	0.30/0.35	0.30/0.35	4500
BB1144	25mm	1"	6	0.30/0.35	0.30/0.35	0.30/0.35	0.30/0.35	4500
BB1145	30mm	1-3/16"	6	0.30/0.35	0.30/0.35	0.30/0.35	0.30/0.35	4500



1/4" Hex Shaft Mounted Cup Brushes Crimped Wire

Fill type:

- S-Steel wire
- BS-brass coated steel wire
- SS-stainless steel wire
- B-Brass wire

Application:

- Quick change shaft makes the brushes loaded on the drill machines conveniently and safety. Cup brushes with shaft are very flexible in surface cleaning.

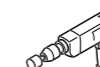

Article Nr.	Diameter (Metric)	Diameter (Inch)	Shank diameter	Fill types (mm)				RPM
				S	BS	B	SS	
BB1146	24mm	1"	6.35	0.3	0.3	0.3	0.3	4500

Shaft Mounted Cup Brushes

Shaft Mounted Cup Brushes Twisted Knot



Fill type:

- ST-Steel wire
- SS-stainless steel wire

Application:

- Cup brushes with shaft are small diameter brushes and good to be used for drill machines. Normally the RPM is 12500. It's good for home work and do-it-yourself works. We have inch size and metric size for your choose. It's very flexible and most popular in use.

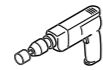

Article Nr.	Diameter (Metric)	Diameter (Inch)	Shank diameter	NO. of wire	ST	RPM
BB1147	75mm	3"	6	18	0.35/0.5	12500

Shaft Mounted Cup Brushes

Shaft Mounted Bevel Brushes Twisted Knot



Fill type:

- ST-Steel wire
- SS-stainless steel wire

Application:

- Cup brushes with shaft are small diameter brushes and good to be used for drill machines. Normally the RPM is 4500. It's good for home work and do-it-yourself works. We have inch size and metric size for your choose. It's very flexible and most popular in use.

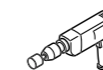

Article Nr.	Diameter (Metric)	Diameter (Inch)	NO. of wire	shank diameter	ST	RPM
BB1151	75mm	3"	15	6	0.35/0.5	12000
BB1152	100mm	4"	18	6	0.35/0.5	11000

Shaft Mounted Circular Brushes Twisted Knot

Fill type:

- ST-Steel wire
- SS-stainless steel wire

Application:

- Cup brushes with shaft are small diameter brushes and good to be used for drill machines. Normally the RPM is 4500. It's good for home work and do-it-yourself works. We have inch size and metric size for your choose. It's very flexible and most popular in use.

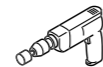

Article Nr.	Diameter (Metric)	Diameter (Inch)	wire thickness	NO. of wire	shank diameter	ST	RPM
BB1148	75mm	3"	6	15	6	0.35/0.5	15000
BB1149	75mm	3"	12	15	6	0.35/0.5	15000
BB1150	100mm	4"	6	18	6	0.35/0.5	12500

Shaft Mounted End Brushes Twisted Knot

Fill type:

- ST-Steel wire
- SS-stainless steel wire

Application:

- Very flexible in use. It's good to clean the corners and awkward areas.

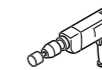

Article Nr.	Diameter (Metric)	Diameter (Inch)	shank diameter	ST	RPM
BB1153	19mm	49/64"	6	0.35/0.5	20000
BB1154	22mm	7/8"	6	0.35/0.5	20000
BB1155	28mm	1-7/64"	6	0.35/0.5	20000

Accessories

Plastic Adapters



Application:
 ■ Plastic adapters for Wire brushes for power tools

Article Nr.	Out diameter	Inner diameter
BB1102	1/2"	1/4"
BB1103	1/2"	3/8"
BB1104	5/8"	1/2"
BB1105	5/8"	5/8"
BB1106	5/8"	3/4"
BB1107	5/8"	7/8"
BB1108	5/8"	1"

Metal Adapters



Application:
 ■ Metal Adapters for Wire brushes for power tools

Article Nr.	Diameter (Metric)	Diameter (Inch)	Inner diameter
BB1109	50	2"	1/2"
BB1110	50	2"	5/8"
BB1111	50	2"	3/4"
BB1112	50	2"	7/8"
BB1113	50	2"	1"
BB1114	50	2"	1-1/4"
BB1115	50	2"	1-1/2"

Exchange screw



Application:
 ■ The drive arbors are mounted on small diameter single section brushes so as to be used for drill machines.
 ■ We have different types of arbors for you to choose. For mounting small diameter wheels to use for drill machines.

Article Nr.	Out diameter	Inner diameter
BB1116	3/8"	1/4"
BB1117	1/2"	1/4"



Application:
 ■ The multi thread can change 5/8"-11 thread to Metric size M14x2. It's also able to change M14x2 thread to smaller size M10x1.25 and M10x1.5.

Article Nr.	Out diameter	Inner diameter
BB1118	5/8"-11UNC	M10X1.25
BB1119	5/8"-11UNC	M10X1.5
BB1120	M14x2	M10X1.25
BB1121	M14x2	M10X1.5

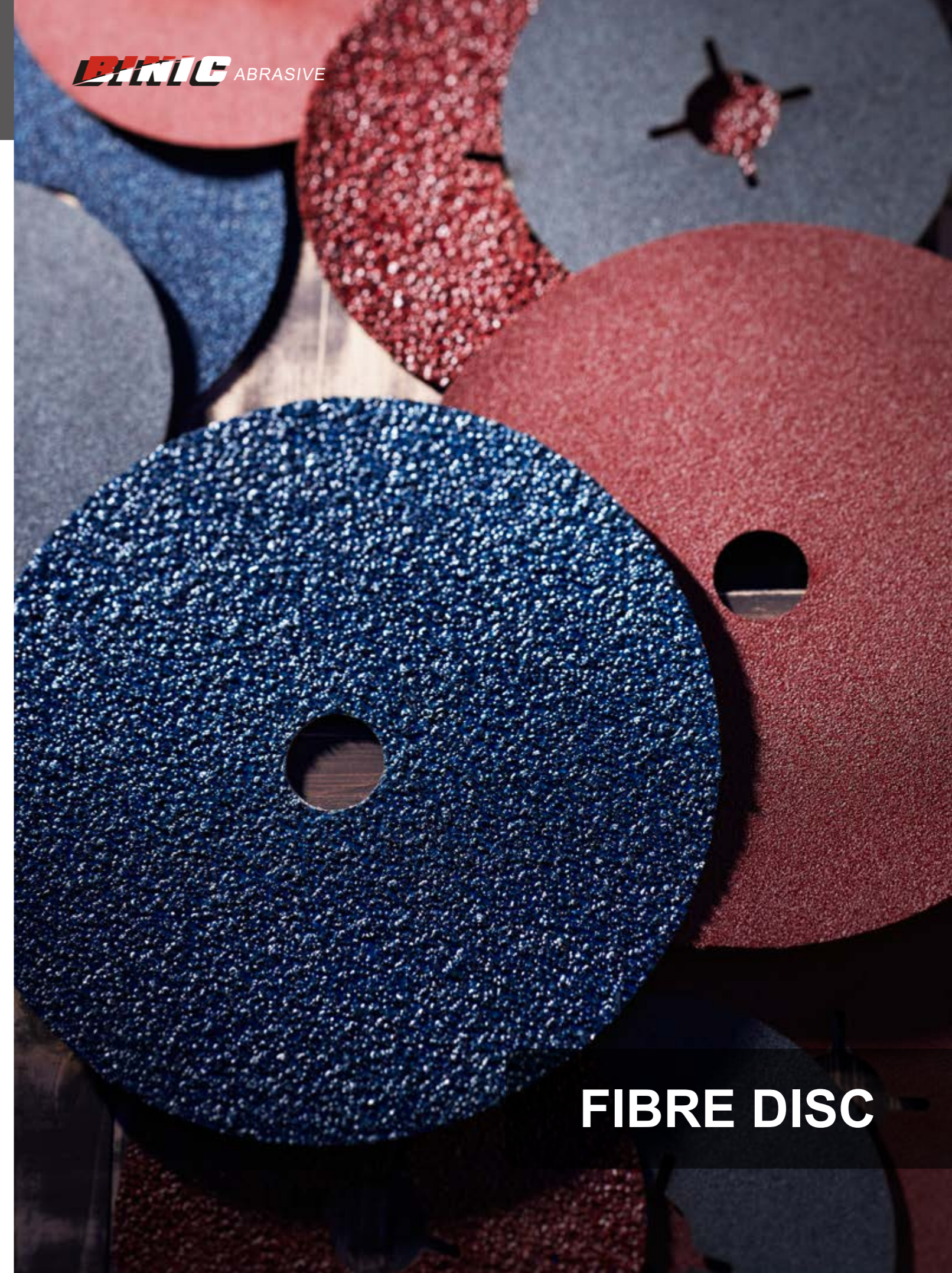

FIBRE DISC

Fibre Discs

BSP fibre discs have high material removal rates and service lives and produce an optimal finish. Suitable backing plates complete the product range. Areas of use are steel, stainless steel, non-ferrous metal and select the right tool for every application. Even the most difficult of surfaces can be worked on easily with the fibre discs.

BSP abrasive fibre discs are outstanding for rough grinding and sanding, de-rusting metal parts, de-burring and grinding welded seams. These discs are also suitable for precision finishing work on metals.

Hole pattern for fibre discs

Round hole



Cross hole

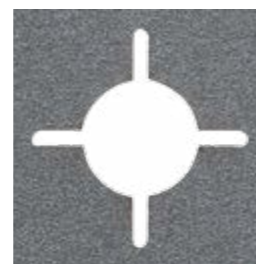

Materials and applications



Aluminium Oxide for S:
For working on steel and NF metals.



Zirconia Alumina for SS/S:
High removal rate for rough grinding and deburring of steel and stainless steel.



Aluminium Oxide for SS:
For processing stainless steel.
High aggressiveness and long service life due to new advanced coating technology.

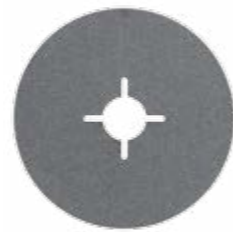

Silicon Carbide for ST:
For working on stone and concrete.

Fibre Disc Aluminium Oxide For Metal For working on steel and NF metals



Article Nr.	Diameter x Hole	Grain	Grit optional
BD1001	100*16mm	A	24-36-40-50-80-100-120-150-180-220-240-280-320-400
BD1002	115*22mm	A	24-36-40-50-80-100-120-150-180-220-240-280-320-400
BD1003	125*22mm	A	24-36-40-50-80-100-120-150-180-220-240-280-320-400
BD1003	150*22mm	A	24-36-40-50-80-100-120-150-180-220-240-280-320-400
BD1005	180*22mm	A	24-36-40-50-80-100-120-150-180-220-240-280-320-400

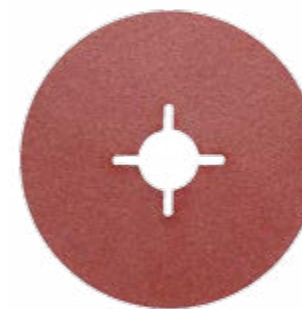

Aluminium Oxide For Stainless Steel For processing stainless steel

High aggressiveness and long service life due to new advanced coating technology.



Article Nr.	Diameter x Hole	Grain	Grit optional
BD1006	100*16mm	A	24-36-40-50-80-100-120-150-180-220-240-280-320-400
BD1007	115*22mm	A	24-36-40-50-80-100-120-150-180-220-240-280-320-400
BD1008	125*22mm	A	24-36-40-50-80-100-120-150-180-220-240-280-320-400
BD1009	150*22mm	A	24-36-40-50-80-100-120-150-180-220-240-280-320-400
BD1010	180*22mm	A	24-36-40-50-80-100-120-150-180-220-240-280-320-400



Zirconia Alumina for Stainless Steel / Steel

High removal rate for rough grinding and deburring of steel and stainless steel



Article Nr.	Diameter x Hole	Grain	Grit optional
BD1011	100*16mm	ZA	24-36-40-50-80-100-120-150-180-220-240-280-320-400
BD1012	115*22mm	ZA	24-36-40-50-80-100-120-150-180-220-240-280-320-400
BD1013	125*22mm	ZA	24-36-40-50-80-100-120-150-180-220-240-280-320-400
BD1014	150*22mm	ZA	24-36-40-50-80-100-120-150-180-220-240-280-320-400
BD1015	180*22mm	ZA	24-36-40-50-80-100-120-150-180-220-240-280-320-400

Ceramic Aluminium Oxide for Stone

For working on stone and concrete



Article Nr.	Diameter x Hole	Grain	Grit optional
BD1016	100*16mm	C	24-36-40-50-80-100-120-150-180-220-240-280-320-400
BD1017	115*22mm	C	24-36-40-50-80-100-120-150-180-220-240-280-320-400
BD1018	125*22mm	C	24-36-40-50-80-100-120-150-180-220-240-280-320-400
BD1019	150*22mm	C	24-36-40-50-80-100-120-150-180-220-240-280-320-400
BD1020	180*22mm	C	24-36-40-50-80-100-120-150-180-220-240-280-320-400

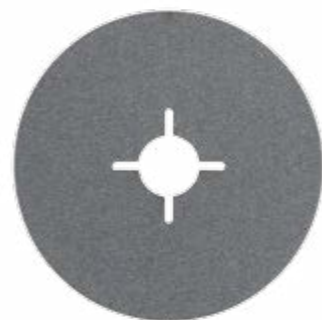

Backing Pad

Rubber backing pad

Art.No	Diam	Thread Size
W918	100mm(4")	M10x1.25
		M10x1.5
		M14x2
W912	115mm(4 1/2")	M10x1.5
		M14x2
		5/8"-11NC
W913	125mm(5")	M14x2
		5/8"-11NC
		M16x2
W914	150mm(6")	M14x2
		5/8"-11NC
		M16x2
W915	180mm(7")	M14x2
		5/8"-11NC
		M16x2

Advantage: Medium hard backing pad allows good adaptation to the workpiece/ For universal use, especially for surface and finish grinding (grit 50 and finer) / High temperature resistance.



Plastic backing pad ripped

Advantage: High performance backing pad with radially extending ribs/ Medium hard rubber for aggressive stock removal. Ripped pads result in cooler running of the discs.



Art.No	Diam	Thread Size
K903	100mm(4")	3/8"x24
		M10x1.25
		M10x1.5
K904	115mm(4 1/2")	M14x2
		M10x1.25
		M10x1.5
K905	125mm(5")	M14x2
		M10x1.5
		5/8"-11NC
K906	150mm(6")	M14x2
		5/8"-11NC
		M16x2
K907	180mm(7")	M14x2
		5/8"-11NC
		M16x2

Plastic backing pad

Advantage: For rough grinding/ Cool grinding/ Increased aggressiveness due to hard, ribbed abrasive surface / High temperature resistance and stability.



Art.No	Diam	Thread Size
K080	80mm(3")	3/8"x24
		M10x1.25
		M10x1.5
K100	100mm(4")	M14x2
		M10x1.25
		M10x1.5
K115	115mm(4 1/2")	M14x2
		M10x1.5
		5/8"-11NC
K125	125mm(5")	M14x2
		5/8"-11NC
		M14x2
K150	150mm(6")	5/8"-11NC
		M16x2
		M14x2
K180	180mm(7")	5/8"-11NC
		M16x2
		M16x2

A large grey rectangular area with a red top border and horizontal lines, serving as a template for text or notes.

